

PRODUCT NUMBER	PITCH
YK304xx0x0J0G	7.62 mm

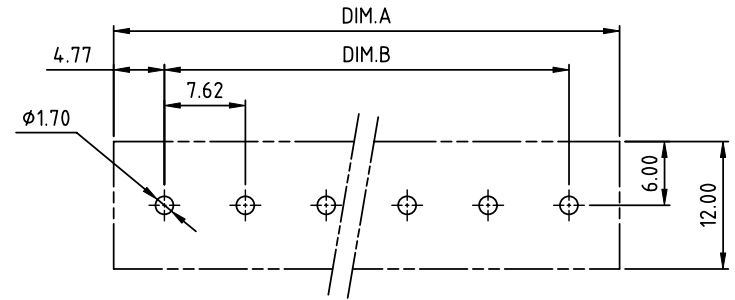

RECOMMENDED P.C.B LAYOUT  
TOP VIEW

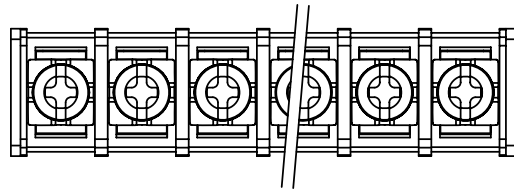
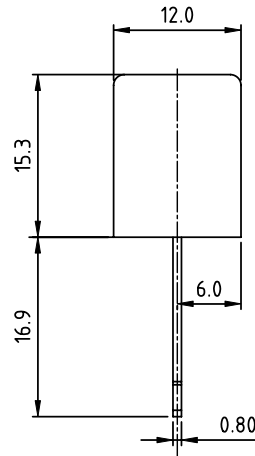
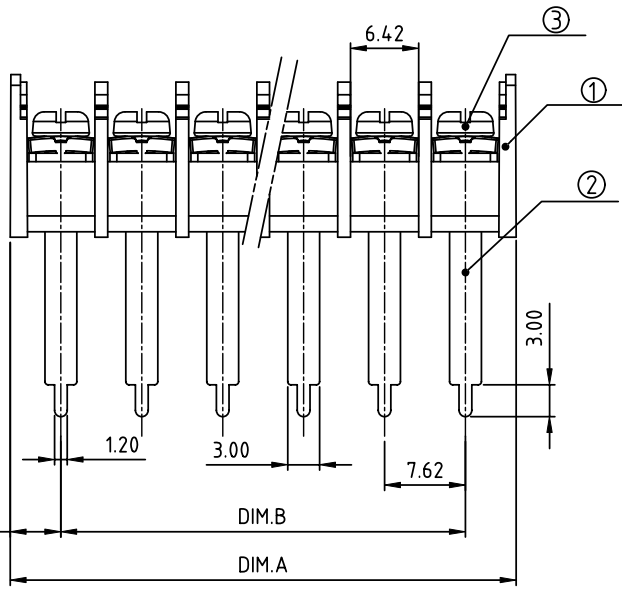

- MATERIALS ELECTRICAL
- RATED VOLTAGE & CURRENT: 300 V, 15 A
- WITHSTAND VOLTAGE: AC 2000 V/Min
- INSULATION RESISTANCE: 1000 MΩ OR MORE AT DC 500 V
- OPERATING TEMPERATURE RANGE: -40 °C ~ +115 °C
- SCREW TORQUE VALUE: 5.2 Lb-In.
- WIRE RANGE: 14 ~ 22 AWG
- 1) HOUSING: THERMOPLASTIC, UL 94 V-0 BLACK
- 2) TERMINAL: BRASS, 0.8t
- 3) TERMINAL SCREWS: STEEL, M3

DIMENSION

Dim A	(N-1)×7.62+9.54
Dim B	(N-1)×7.62

N=Number of poles

Poles	Tolerance
2p-4p	±0.20
5p-10p	±0.30
11p-16p	±0.40
17p-20p	±0.50

PART NO.: YK 304xx 0 x 0 J0G

No. of poles

02 2 poles

03 3 poles

... ..

20 20 poles

Plated

Code	Terminal	Screw
0	G/F	G/F
1	G/F	Zinc
2	Tin	G/F
3	Tin	Zinc

RoHS compliant (lead<4%)  
In copper Alloy

mat'l. code		surface ASME Y14.5 ✓	tolerance ASME Y14.5	projection	product family
ltr	ecn no	dr	date	tolerances unless otherwise specified	TERMINAL BLOCK
				angles	title
				X°±1'	TERMINAL BLOCK
				scale	BARRIER TYPE
				dr HANKE FENG 060914	dwg no
				enr HANKE FENG 060914	YK304xx0x0J0G
				chr HANKE FENG 060914	sheet 1 of 1
				appd SHI JUN 060914	size A4
sheet index	revision sheet	A	1	FCI	type CUSTOMER Drawing