



Chipsmall Limited consists of a professional team with an average of over 10 year of expertise in the distribution of electronic components. Based in Hongkong, we have already established firm and mutual-benefit business relationships with customers from,Europe,America and south Asia,supplying obsolete and hard-to-find components to meet their specific needs.

With the principle of “Quality Parts,Customers Priority,Honest Operation,and Considerate Service”,our business mainly focus on the distribution of electronic components. Line cards we deal with include Microchip,ALPS,ROHM,Xilinx,Pulse,ON,Everlight and Freescale. Main products comprise IC,Modules,Potentiometer,IC Socket,Relay,Connector.Our parts cover such applications as commercial,industrial, and automotives areas.

We are looking forward to setting up business relationship with you and hope to provide you with the best service and solution. Let us make a better world for our industry!



Contact us

Tel: +86-755-8981 8866 Fax: +86-755-8427 6832

Email & Skype: info@chipsmall.com Web: www.chipsmall.com

Address: A1208, Overseas Decoration Building, #122 Zhenhua RD., Futian, Shenzhen, China



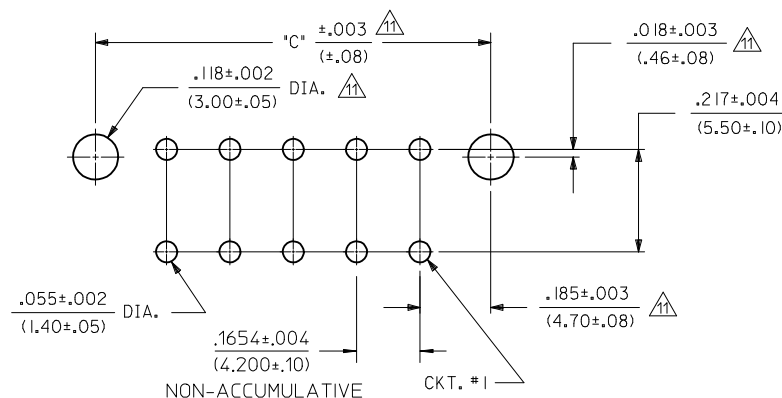
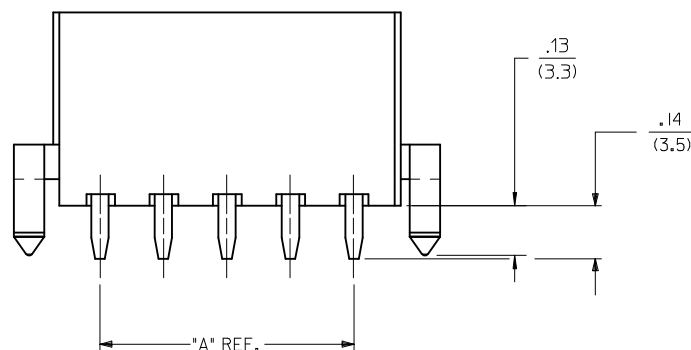
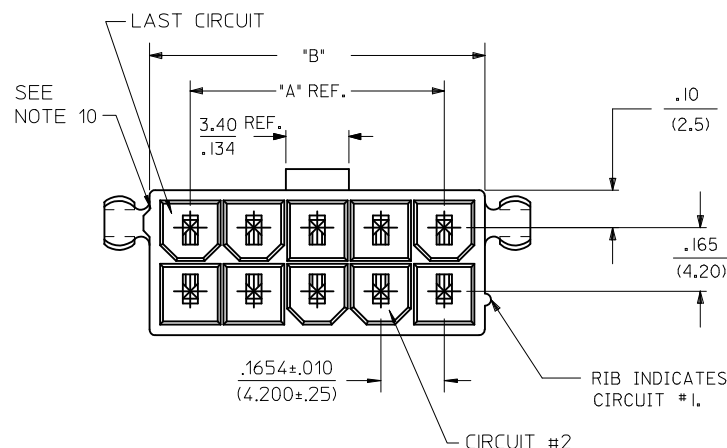
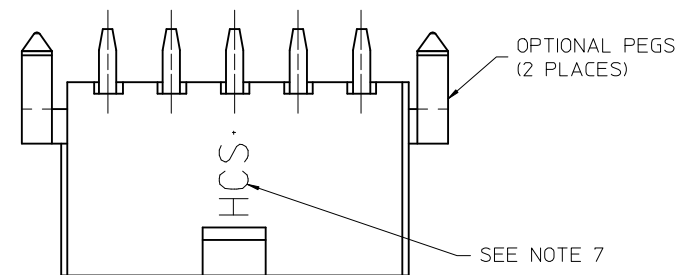

RECOMMENDED HOLE LAYOUT FOR
.070/(1.78) MAX. THICK P. C. BOARD

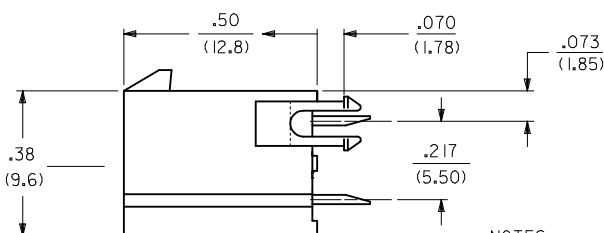

NOTES:

- HOUSING MATERIAL:
GW V-2 = NYLON UL94V-2, COLOR: BLACK
IEC 60335-1 5TH EDITION GLOW WIRE CAPABLE
- TERMINAL MATERIAL: COPPER ALLOY.
- TERMINAL PLATING:
TIN = .000100/(.00254) MIN. MATTE TIN OVER .000050/(.00127) MIN. NICKEL OVERALL
GOLD = .000030/(.00080) MIN. SELECT GOLD, .000100/(.00254) MIN. MATTE TIN OVER .000050/(.00127) MIN. NICKEL OVERALL
- PRODUCT SPECIFICATION: PS-45750-001
- PACKAGING SPECIFICATION: PK-5566-001.
- PART MATES WITH MINI-FIT JR. RECEPTACLE NO. 46992
- PART ARE NOT TO BE MATED OR UN-MATED WHILE CIRCUITS ARE LIVE.
- PARTS TO HAVE "HCS+" MARKING
- PART CONFORMS TO CLASS B OF COSMETIC SPECIFICATION PS-45499-002 WITH THE EXCEPTION OF DISCOLORATION, FLASH, AND SINK MEET CLASS "C" REQUIREMENTS.
- PART IS NOT DESIGNED FOR CURRENT SHARING.
- ANTI-SHINGLING RIB MAY OR MAY NOT APPEAR ON HOUSINGS.
- ⚠ LOCATION OF .118/3.00 DIAMETER HOLES ON P.C. BOARD IS FOR OPTIONAL PEGS.

CIRCUIT SIZE	DIM. "A"	DIM. "B"	DIM. "C"
2	—	.21 (5.4)	.370 (9.40)
4	.17 (4.2)	.38 (9.6)	.535 (13.60)
6	.33 (8.4)	.54 (13.8)	.701 (17.80)
8	.50 (12.6)	.71 (18.0)	.866 (22.00)
10	.66 (16.8)	.87 (22.2)	1.031 (26.20)
12	.83 (21.0)	1.04 (26.4)	1.197 (30.40)
14	.99 (25.2)	1.20 (30.6)	1.362 (34.60)
16	1.16 (29.4)	1.37 (34.8)	1.528 (38.80)
18	1.32 (33.6)	1.54 (39.0)	1.693 (43.00)
20	1.49 (37.8)	1.70 (43.2)	1.858 (47.20)
22	1.65 (42.0)	1.87 (47.4)	2.024 (51.40)
24	1.82 (46.2)	2.03 (51.6)	2.189 (55.60)

CREATE DRAWING EC NO: UCP2014-4789 DRWN: JDOX 2014/05/15 CHKD: JBELL 2014/05/19 APPR: FSMITH 2014/06/23 A	DESCRIPTION REV	QUALITY SYMBOLS ▽=0 ▽=0 ▽=0	GENERAL TOLERANCES (UNLESS SPECIFIED)			DIMENSION STYLE IN/MM		SCALE 4:1	DESIGN UNITS METRIC	THIRD ANGLE PROJECTION				
						DRAWN BY JDOFX	DATE 2014/05/15	TITLE VERTICAL HEADER ASSEMBLY DUAL ROW GLOW WIRE MINI-FIT PLUS HCS SERIES						
						CHECKED BY JBELL	DATE 2014/05/19							
						APPROVED BY FSMITH	DATE 2014/06/23	molex						
						MATERIAL NO.							DOCUMENT NO.	
						SEE TABLE		SD-172675-0000		1 OF 2				
						THIS DRAWING CONTAINS INFORMATION THAT IS PROPRIETARY TO MOLEX INCORPORATED AND SHOULD NOT BE USED WITHOUT WRITTEN PERMISSION								

	13	12		11		10		9	8	7	6	5	4	3	2	1					
J	ITEM NO.	CKT SIZE	HOUSING MATERIAL	PEGS	PLATING																
	172675-0213	2	GW V-2	YES	TIN																
	172675-0214		GW V-2	YES	GOLD																
	172675-0413	4	GW V-2	YES	TIN																
	172675-0414		GW V-2	YES	GOLD																
	172675-0613	6	GW V-2	YES	TIN																
	172675-0614		GW V-2	YES	GOLD																
	172675-0813	8	GW V-2	YES	TIN																
	172675-0814		GW V-2	YES	GOLD																
	172675-1013	10	GW V-2	YES	TIN																
	172675-1014		GW V-2	YES	GOLD																
	172675-1213	12	GW V-2	YES	TIN																
	172675-1214		GW V-2	YES	GOLD																
H																					
G																					
F																					
E																					
D																					
C																					
B																					
A																					
SEE SHEET 1		EC NO: UCP2014-4789		2014/05/15		2014/05/19		2014/06/23		QUALITY SYMBOLS		GENERAL TOLERANCES (UNLESS SPECIFIED)		DIMENSION STYLE IN/MM		SCALE 1:1		DESIGN UNITS METRIC		THIRD ANGLE PROJECTION	
A		DRWN:JDFOX		2014/05/15		CHKD:JBELL		2014/05/19		APPR:FSMITH		2014/06/23		REV		DESCRIPTION		4 PLACES ± --- ± ---		5 PLACES ± --- ± ---	
																		3 PLACES ± --- ± .010		4 PLACES ± --- ± .020	
																		2 PLACES ± 0.25 ± .020		3 PLACES ± 0.25 ± .020	
																		1 PLACE ± 0.50 ± ---		2 PLACES ± 0.50 ± ---	
																		0 PLACE ± ±		1 PLACE ± ±	
																		ANGULAR ±1/2°		DRAFT WHERE APPLICABLE MUST REMAIN WITHIN DIMENSIONS	
																		MATERIAL NO.		DOCUMENT NO.	
																		SEE CHART		SD-172675-0000	
																		SIZE C		THIS DRAWING CONTAINS INFORMATION THAT IS PROPRIETARY TO MOLEX INCORPORATED AND SHOULD NOT BE USED WITHOUT WRITTEN PERMISSION	
	12	11	10	9	8	7	6	5	4	3	2	1									