



Chipsmall Limited consists of a professional team with an average of over 10 year of expertise in the distribution of electronic components. Based in Hongkong, we have already established firm and mutual-benefit business relationships with customers from,Europe,America and south Asia,supplying obsolete and hard-to-find components to meet their specific needs.

With the principle of “Quality Parts,Customers Priority,Honest Operation,and Considerate Service”,our business mainly focus on the distribution of electronic components. Line cards we deal with include Microchip,ALPS,ROHM,Xilinx,Pulse,ON,Everlight and Freescale. Main products comprise IC,Modules,Potentiometer,IC Socket,Relay,Connector.Our parts cover such applications as commercial,industrial, and automotives areas.

We are looking forward to setting up business relationship with you and hope to provide you with the best service and solution. Let us make a better world for our industry!



## Contact us

Tel: +86-755-8981 8866 Fax: +86-755-8427 6832

Email & Skype: [info@chipsmall.com](mailto:info@chipsmall.com) Web: [www.chipsmall.com](http://www.chipsmall.com)

Address: A1208, Overseas Decoration Building, #122 Zhenhua RD., Futian, Shenzhen, China



# Ultra-Low Phase Jitter LVCMOS SMD Clock Oscillator

ASFLMX-25.000MHz-5ABH



ESD Sensitive



RoHS/RoHS II compliant

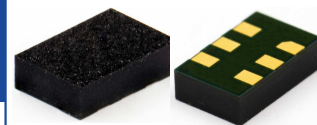

5.0 x 3.2 x 1.4mm

Moisture Sensitivity Level – MSL 3

## FEATURES:

- 25MHz LVCMOS
- Typical phase noise: 100fs (Integration range: 1.875MHz-20MHz)
- $\pm 50$ ppm total frequency stability over -40°C to +85°C temperature range
- Industry standard 6-Pin 5 x 3.2mm LGA package

## APPLICATIONS:

- Communications
- Backplane reference clock
- SERDES reference clock
- FPGA

## KEY ELECTRICAL SPECIFICATIONS

### Absolute Maximum Ratings

Item	Minimum	Maximum	Unit	Condition
Supply Voltage	-0.3	+3.6	V	
Storage Temp.	-55	+125	°C	
Lead Temp.(soldering, 10s)		+260	°C	
ESD (HBM)		2	kV	

VDD = 2.375 - 3.63V, TA = -40°C to +85°C, outputs terminated with 50 Ohms to VDD/2.<sup>(1)</sup>

Parameters		Minimum	Typical	Maximum	Units	Notes
Frequency		25.000			MHz	
Operating Temperature (TA)		-40		+85	°C	
Overall Frequency Stability <sup>(2)</sup>		-50		+50	ppm	
Supply Voltage (VDD)		+2.375		+3.63	V	
Supply Current (IDD)				95	mA	
Output Logic Level	V <sub>OH</sub>	V <sub>DD</sub> - 0.8			V	
	V <sub>OL</sub>			0.6	V	
Input Logic Level	V <sub>IH</sub>	2		V <sub>DD</sub> + 0.3	V	
	V <sub>IL</sub>	-0.3		0.8	V	
Start-up Time				20	ms	
Rise Time (Tr)		100		500	ps	No load 20% to 80%
Fall Time (Tf)		100		500		
Duty Cycle		45		55	%	
Phase Noise	Integration Range: 12kHz to 20MHz		220		fsRMS	
	Integration Range: 1.875MHz to 20MHz		100			

### Notes:

1. Guaranteed after thermal equilibrium
2. Inclusive of initial accuracy, temperature drift, aging, shock, vibration from -40°C to +85°C.

## PART IDENTIFICATION

ASFLMX-25.000MHz -5ABH -



### Packing

Blank: Bulk or Tube

T: Tape & Reel (1k/reel)

# Ultra-Low Phase Jitter LVCMOS SMD Clock Oscillator

ASFLMX-25.000MHz-5ABH



RoHS/RoHS II compliant

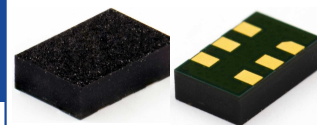

5.0 x 3.2 x 1.4mm

## OUTLINE DIMENSION

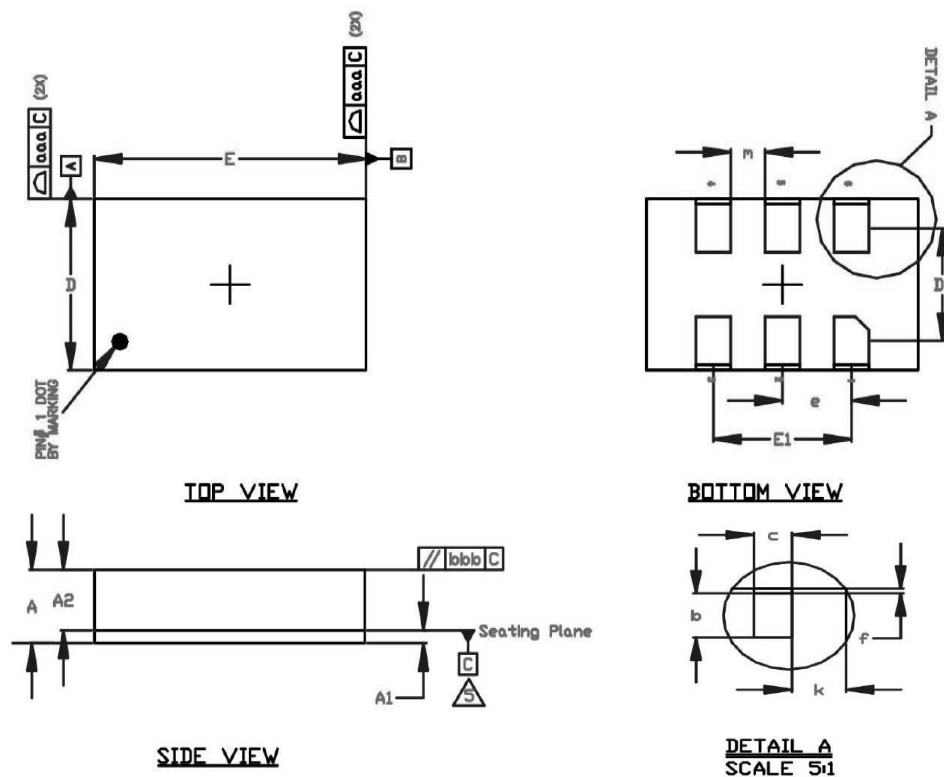

Ref.	Min.	Nom.	Max.
A	1.260	1.330	1.400
A1	0.190	0.230	0.270
A2	1.070	1.100	1.130
D	3.100	3.200	3.300
D1	2.100 BSC		
E	4.900	5.000	5.100
E1	2.540 BSC		
b	0.850	0.900	0.950
c	0.850	0.900	0.950
e	1.270 BSC		
f	0.050	0.100	0.150
k	0.860	0.910	0.960
m	0.580	0.630	0.680
n		6	

Dimensional Tolerance	
aaa	0.100
bbb	0.070

## Recommended Land Pattern

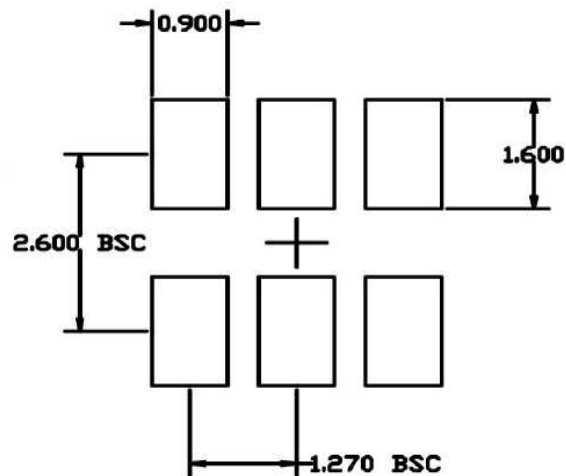

Dimensions: mm



# Ultra-Low Phase Jitter LVCMOS SMD Clock Oscillator

ASFLMX-25.000MHz-5ABH



RoHS/RoHS II compliant

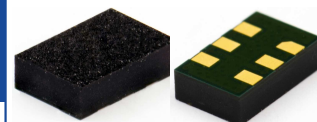

5.0 x 3.2 x 1.4mm

## PIN CONFIGURATION

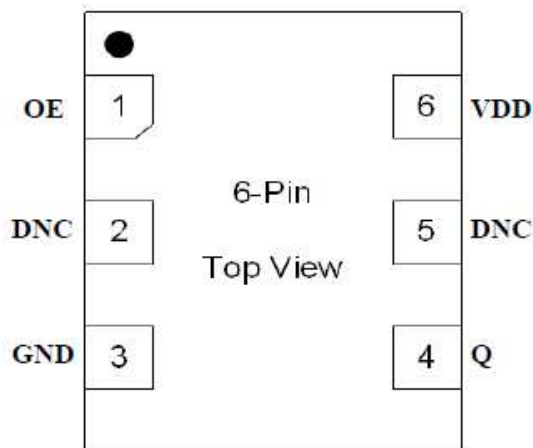

Pin #	Pin Name	Pin Type	Pin Level	Pin Function
1	OE	I, SE	LVCMOS	Output Enable, disables output to tri-state. 1 = Disabled, 0 = Enabled, 50k $\Omega$ Pull-up
2	DNC			Make no connection, leave floating
3	GND	PWR		Power Supply Ground
4	Q	O	LVCMOS	Clock Output
5	DNC			Make no connection, leave floating
6	VDD	PWR		Power Supply

## REFLOW PROFILE

Lead-free Reflow Profile

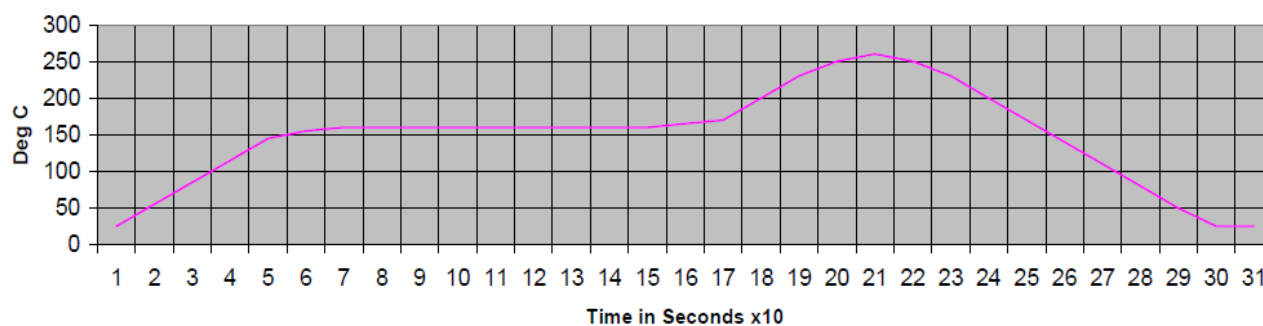

Parameters	Specifications
Average Ramp-up Rate	3°C /second max.
Pre-Heat Temp 150 – 200°C	60 – 180 second
Temp > 217°C	60 – 150 second
Time @ Peak Temperature	20 – 40 second
Peak Temperature	260°C + 0°C / -5°C
Ramp-down Rate	-6°C / second max.
Time 25°C to Peak Temp.	8 minutes max.

# Ultra-Low Phase Jitter LVCMOS SMD Clock Oscillator

ASFLMX-25.000MHz-5ABH



RoHS/RoHS II compliant

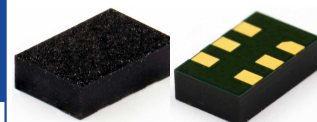

5.0 x 3.2 x 1.4mm

## TAPE & REEL

**T= Tape & Reel, 1000pcs/reel. Reel Size = 7-inch Reel**

**MSL-3 packaging applies to -T option.**

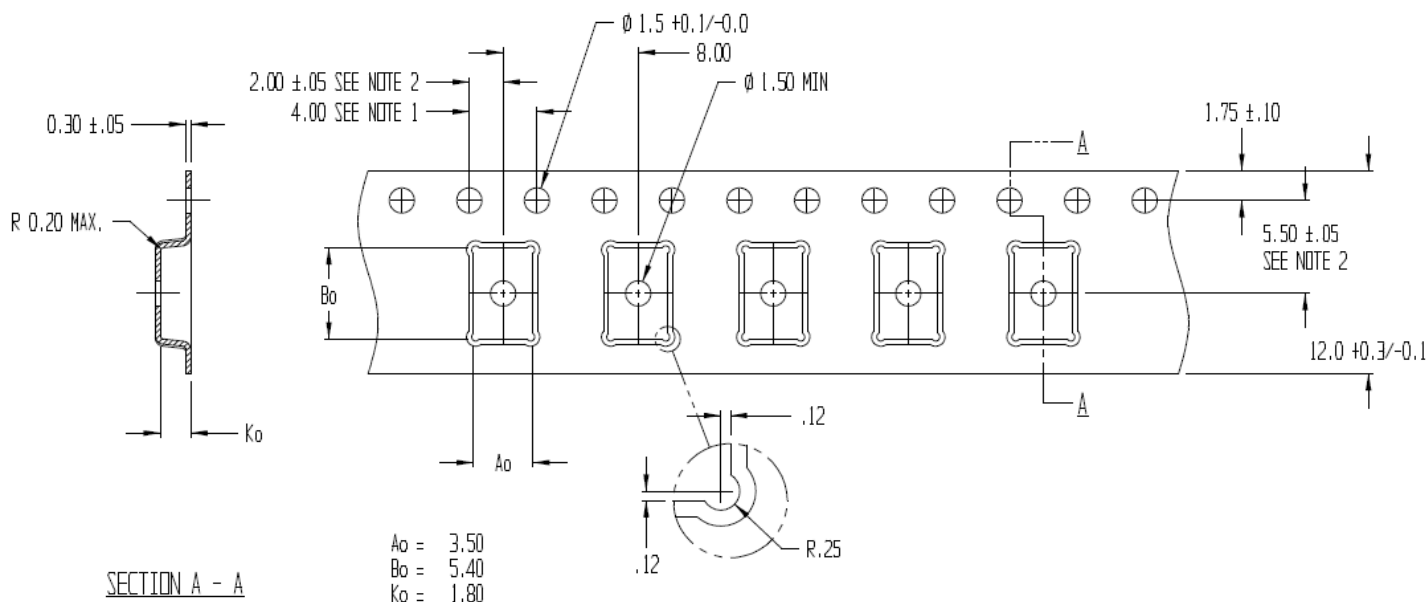

**Blank = Bulk or Tube (60pcs/tube)**

**MSL-3 packaging applies to MOQ=60 units (tube)**

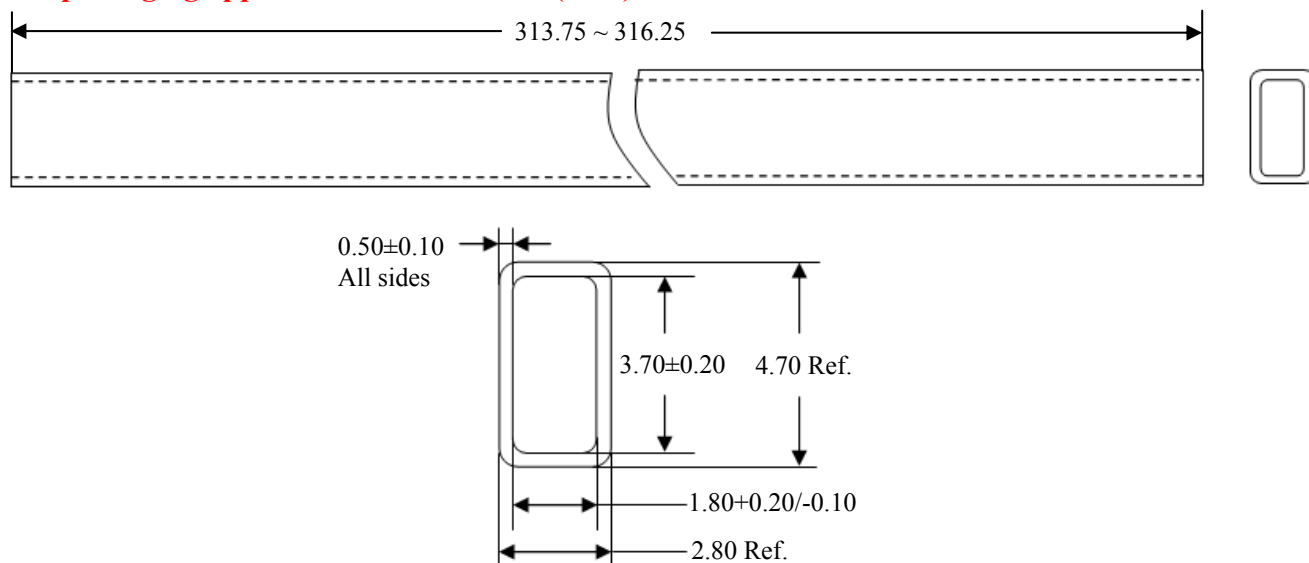

**Dimensions: mm**

**ATTENTION:** Abracon Corporation's products are COTS – Commercial-Off-The-Shelf products; suitable for Commercial, Industrial and, where designated, Automotive Applications. Abracon's products are not specifically designed for Military, Aviation, Aerospace, Life-dependant Medical applications or any application requiring high reliability where component failure could result in loss of life and/or property. For applications requiring high reliability and/or presenting an extreme operating environment, written consent and authorization from Abracon Corporation is required. Please contact Abracon Corporation for more information.

ABRACON IS  
ISO9001:2008  
CERTIFIED



**ABRACON**<sup>®</sup>  
LLC

2 Faraday, Suite# B | Irvine | CA 92618 **Revised: 04.15.15**

Ph. 949.546.8000 | Fax. 949.546.8001

Visit [www.abracon.com](http://www.abracon.com) for Terms and Conditions of Sale