



Chipsmall Limited consists of a professional team with an average of over 10 year of expertise in the distribution of electronic components. Based in Hongkong, we have already established firm and mutual-benefit business relationships with customers from,Europe,America and south Asia,supplying obsolete and hard-to-find components to meet their specific needs.

With the principle of “Quality Parts,Customers Priority,Honest Operation,and Considerate Service”,our business mainly focus on the distribution of electronic components. Line cards we deal with include Microchip,ALPS,ROHM,Xilinx,Pulse,ON,Everlight and Freescale. Main products comprise IC,Modules,Potentiometer,IC Socket,Relay,Connector.Our parts cover such applications as commercial,industrial, and automotives areas.

We are looking forward to setting up business relationship with you and hope to provide you with the best service and solution. Let us make a better world for our industry!



Contact us

Tel: +86-755-8981 8866 Fax: +86-755-8427 6832

Email & Skype: info@chipsmall.com Web: www.chipsmall.com

Address: A1208, Overseas Decoration Building, #122 Zhenhua RD., Futian, Shenzhen, China



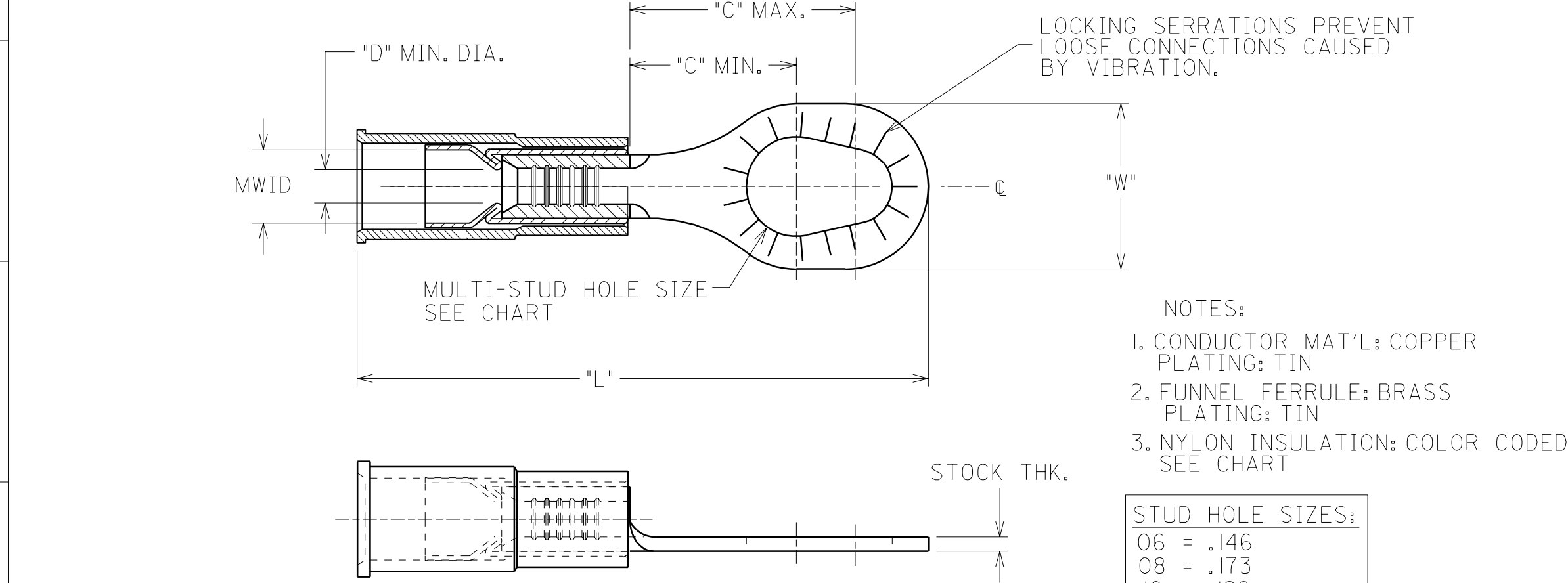

MWID = MAX. WIRE INSULATION DIA.
PART NUMBERS ARE FOR LOOSE PIECE TO ORDER PARTS ON TAPE ADD A "T" TO END OF PART NUMBER

PART NUMBER	WIRE RANGE AWG	INSUL. COLOR	"L" MAX.	"W" MAX.	"C" MIN.	"C" MAX.	"D" MIN.	MWID	STUD SIZE RANGE FOR EA. PART No.	STOCK THICKNESS
A-5006-MS	22-18	RED	1.064	.348	.330	.447	.062	.140	6 , 8 , 10	.028
B-5006-MS	16-14	BLUE	1.064	.362	.330	.447	.081	.170	6 , 8 , 10	.031
C-5006-MS	12-10	YELLOW	1.305	.410	.330	.447	.128	.225	6 , 8 , 10	.040

DIMENSIONS SHOWN (METRIC) INCH

UNLESS OTHERWISE SPECIFIED
TOLERANCES: ANGULAR $\pm 1/2^{\circ}$

	INCH	METRIC
3 PLACE	$\pm .005$	$\pm ---$
2 PLACE	$\pm .01$	± 0.13
1 PLACE	$\pm ---$	± 0.25

DRAFT WHERE APPLICABLE MUST
REMAIN WITHIN DIMENSIONS

DRWG. BY

EMF

CHK'D. BY

RWD

APP'D. BY

RWD

SCALE

NO:NE

REVISE ONLY ON CAD SYSTEM

TITLE

VIBRAKRIMP
MULTI-STUD
RING TONGUE TERMINAL

molex

ETC INC.

PINELLAS PARK, FLA. 33781 U.S.A.

SHEET NO.

93/02/22

PART NO.

SEE TABLE

DRWG. NO.

MSRINGCD

FILE NAME

MSRINGCD

THIS DRAWING CONTAINS INFORMATION THAT IS PROPRIETARY TO
MOLEX-ETC INC. AND SHOULD NOT BE USED WITHOUT WRITTEN PERMISSION.

DIV.

B

SIZE

B

CUSTOMER DRAWING

10987654321