



Chipsmall Limited consists of a professional team with an average of over 10 year of expertise in the distribution of electronic components. Based in Hongkong, we have already established firm and mutual-benefit business relationships with customers from,Europe,America and south Asia,supplying obsolete and hard-to-find components to meet their specific needs.

With the principle of “Quality Parts,Customers Priority,Honest Operation,and Considerate Service”,our business mainly focus on the distribution of electronic components. Line cards we deal with include Microchip,ALPS,ROHM,Xilinx,Pulse,ON,Everlight and Freescale. Main products comprise IC,Modules,Potentiometer,IC Socket,Relay,Connector.Our parts cover such applications as commercial,industrial, and automotives areas.

We are looking forward to setting up business relationship with you and hope to provide you with the best service and solution. Let us make a better world for our industry!



## Contact us

Tel: +86-755-8981 8866 Fax: +86-755-8427 6832

Email & Skype: [info@chipsmall.com](mailto:info@chipsmall.com) Web: [www.chipsmall.com](http://www.chipsmall.com)

Address: A1208, Overseas Decoration Building, #122 Zhenhua RD., Futian, Shenzhen, China



Technical drawing of a stepped shaft. The drawing shows a shaft with two steps. The top step has a diameter of  $6.3^{+0.1}_0$  and a length of  $4.2^{+0.1}_0$ . The bottom step has a diameter of  $b^{+0.1}_0$  and a total length of  $10.1^{+0.1}_0$ . The drawing includes a centerline and dimension lines with arrows indicating the extent of the dimensions.

NOTE 2

**NOTE 1**

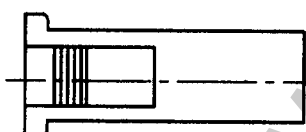
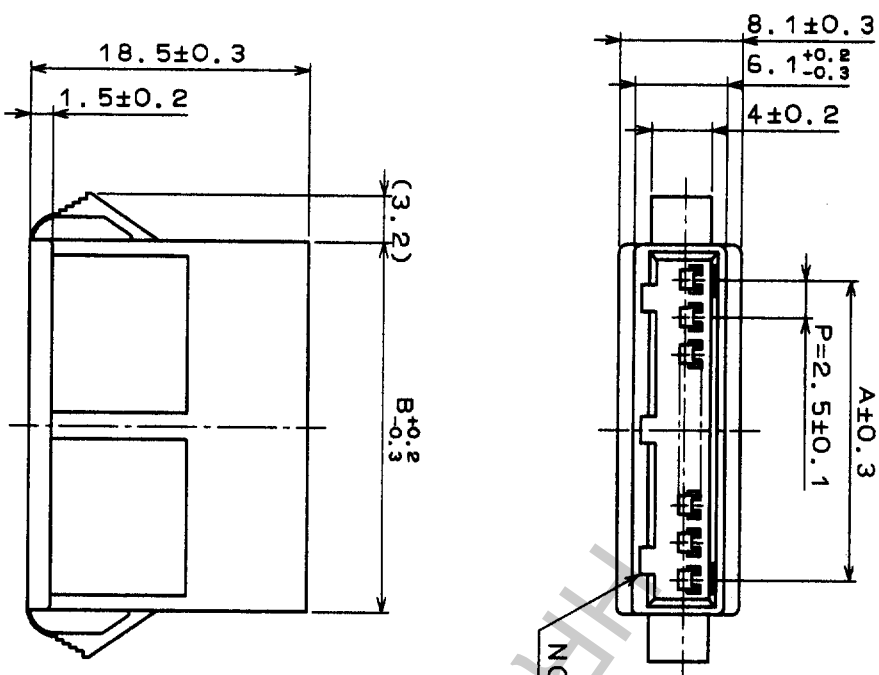

CONCAVE PORTION TO PREVENT CONNECTOR  
MISINSERTION SHALL BE APPLIED ONE AT THE  
CENTER FOR 2 CONTACTS. TWO AT BOTH ENDS FOR  
3 TO 6 CONTACTS AND 3 FOR ANOTHER NUMBER OF  
CONTACT AS THE FIGURE SHOWN.

2: WHEN YOU MOUNT DF1BA RELAY SOCKET ON A PANEL, PLEASE TAKE NOTE OF DIMENSIONS \*a\* INDICATED IN THE TABLE ABOVE. BECAUSE THE CUT-OUT DIMENSION DEPENDS ON PANEL THICKNESS. THE PANEL CUT-OUT SHALL BE FREE FROM BURR

NO.		MATERIAL		FINISH, REMARKS		1		POLYAMIDE		NATURAL(WHITE) UL94V-0	
CODE NO. (OLD)				DRAWN		DESIGNED		CHECKED		APPROVED	
				R. SASAKI		M. Tanaka		J. Owa		H. Yamano	
				951011		95.10.23		95.10.23		95.10.23	
 SCALE 2 : 1		DRAWING NO. EDC3-160595		PART NO. DF1BA-SEP-2.5RC							
UNITS mm		HRS HIROSE ELECTRIC CO., LTD.		CODE NO.		CODE NO.		CODE NO.		SHALL BE IN ACCORDANCE WITH TABLE.	
										1 / 1	