



Chipsmall Limited consists of a professional team with an average of over 10 year of expertise in the distribution of electronic components. Based in Hongkong, we have already established firm and mutual-benefit business relationships with customers from,Europe,America and south Asia,supplying obsolete and hard-to-find components to meet their specific needs.

With the principle of “Quality Parts,Customers Priority,Honest Operation,and Considerate Service”,our business mainly focus on the distribution of electronic components. Line cards we deal with include Microchip,ALPS,ROHM,Xilinx,Pulse,ON,Everlight and Freescale. Main products comprise IC,Modules,Potentiometer,IC Socket,Relay,Connector.Our parts cover such applications as commercial,industrial, and automotives areas.

We are looking forward to setting up business relationship with you and hope to provide you with the best service and solution. Let us make a better world for our industry!



Contact us

Tel: +86-755-8981 8866 Fax: +86-755-8427 6832

Email & Skype: info@chipsmall.com Web: www.chipsmall.com

Address: A1208, Overseas Decoration Building, #122 Zhenhua RD., Futian, Shenzhen, China





表 2 (TABLE 2)

| トレードマーク (TRADE MARK) | 生産場所 (MANUFACTURING PLACE) |
|-------------------------|-------------------------------|
| -AMP OR AMP | 日本 (JAPAN) |
| -+AMP OR AMP | 中国 (CHINA(POC)) |

| | | |
|--------------------------|--------------|-------------|
| プラグハウジング PLUG HOUSING | 1 | 316768-□ |
| キャップハウジング CAP HOUSING | 1 | 316769-□ |
| 嵌合相手側製品 MATING CONN, | 極数 (Pos.) | 型番 (P/N) |

表 1
TABLE. 1

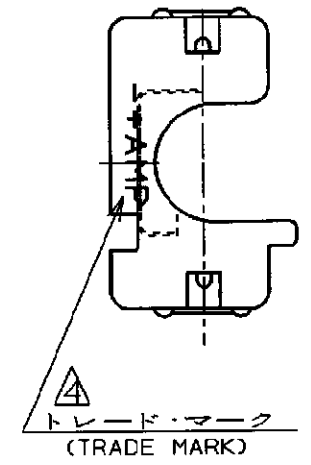
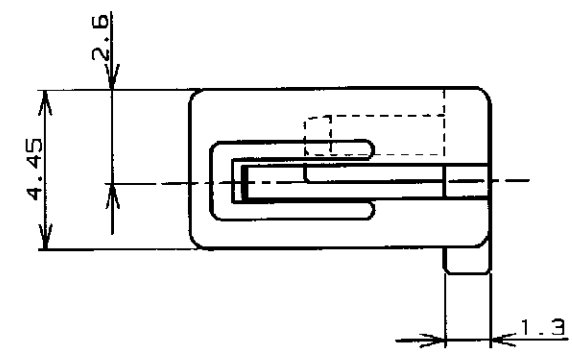
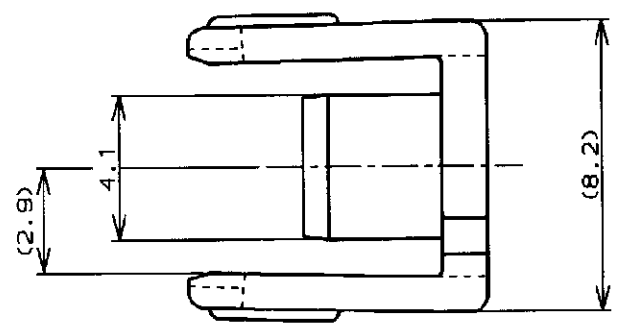
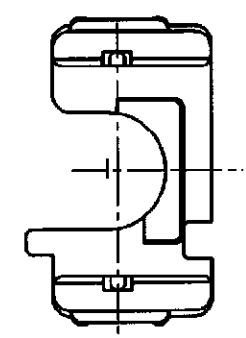
| | | |
|-------------------------|--------------|-------------|
| 自然色(NATURAL) | 1 | 316770-1 |
| プレート色調 (PLATE COLOR) | 極数 (Pos.) | 型番 (P/N) |

- 注,
1.適用製品規格:108-5410
2.嵌合相手側製品型番:表1参照
3.取扱説明書:411-5638
△表2参照
- NOTES;
1.PRODUCT SPEC:108-5410
2.MATING CONN,P/N:SEE FIG.1
3.INSTRUCTION SHEET:411-5638
△SEE TABLE 2

| | | | | | | | | | | | |
|--|--|--|--|--|--|--|--|---|--|--|--|
| Copyright ©19 年 日本エー・エム・ピー株式会社 | | | | Copyright ©19__ AMP (Japan). LTD. ALL RIGHTS RESERVED. | | | | AMP 日本エー・エム・ピー株式会社 Tokyo, Japan | | | |
| 適合電線断面積 (WIRE RANGE) — 1.3 — mm ² (AWG —) | | | | 被覆外径 (INSULATION DIA.) 1.3 — 2.8 mmφ | | | | 名称 (NAME) アンプ パワー ダブルロック コネクタ 1極 3.96mmピッチ ダブルロック プレート AMP POWER DOUBLE LOCK CONN. 3.96mm PITCH DBL LOCK PLATE 1Pos | | | |
| 材料 (MATERIAL) 6/6 ナイロン ガラス強化 (UL94V-0) 6/6 NYLON GLASS FIBER (UL94V-0) | | | | 仕上 (FINISH) — 1.3 — | | | | 一般公差 (GENERAL TOLERANCE) 10以下: ±0.2 10~30以下: ±0.25 30~100以下: ±0.3 角 度: ±3° | | | |
| A 変更 FJ00-0953-98 T.Y. M.S. 28FEB '96 | | | | DR. 20.FEB '96 DE. 20.FEB '96 | | | | B J LOC 番号 (No.) C-316770 | | | |
| O 作成 FJ00-3888-95 N.N. M.S. 28FEB '96 | | | | CHK. 20.FEB '96 DE. 28.FEB '96 | | | | 尺度 (SCALE) REV. A SHEET 1 OF 1 | | | |
| LTR 変更 (REVISION RECORD) DR CHK DATE | | | | CHK. 26.FEB '96 APP. Y. KASHIWA | | | | | | | |