



Chipsmall Limited consists of a professional team with an average of over 10 year of expertise in the distribution of electronic components. Based in Hongkong, we have already established firm and mutual-benefit business relationships with customers from,Europe,America and south Asia,supplying obsolete and hard-to-find components to meet their specific needs.

With the principle of “Quality Parts,Customers Priority,Honest Operation,and Considerate Service”,our business mainly focus on the distribution of electronic components. Line cards we deal with include Microchip,ALPS,ROHM,Xilinx,Pulse,ON,Everlight and Freescale. Main products comprise IC,Modules,Potentiometer,IC Socket,Relay,Connector.Our parts cover such applications as commercial,industrial, and automotives areas.

We are looking forward to setting up business relationship with you and hope to provide you with the best service and solution. Let us make a better world for our industry!



Contact us

Tel: +86-755-8981 8866 Fax: +86-755-8427 6832

Email & Skype: info@chipsmall.com Web: www.chipsmall.com

Address: A1208, Overseas Decoration Building, #122 Zhenhua RD., Futian, Shenzhen, China



THIS DRAWING IS UNPUBLISHED.

RELEASED FOR PUBLICATION

© COPYRIGHT BY TYCO ELECTRONICS CORPORATION. ALL RIGHTS RESERVED.

LOC		DIST		REVISIONS					
CM	00	P	LTR	DESCRIPTION			DATE	DWN	APVD
			G	REVISED PER EC 0G3B-0910-04			15-MAR-05	SH	DC

D

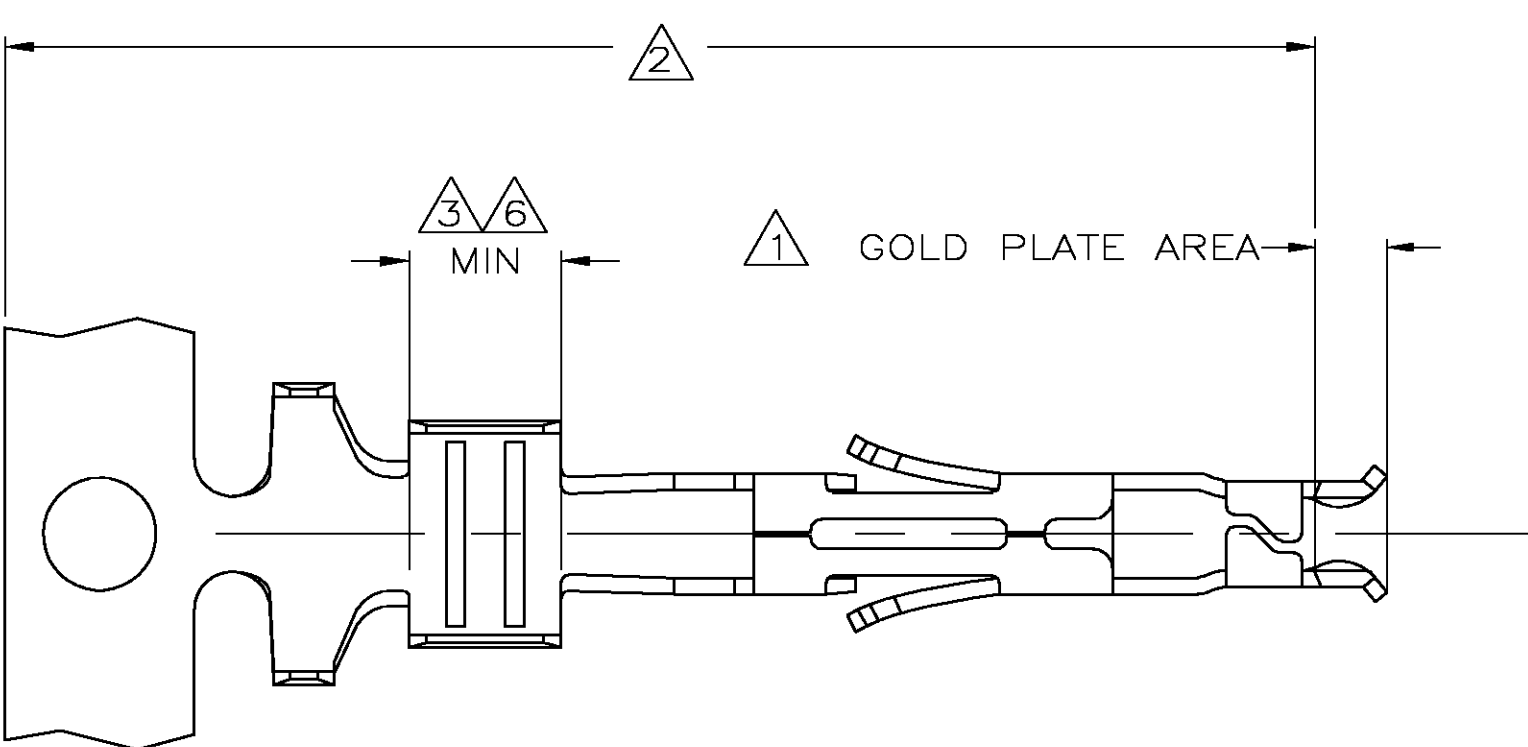

- 1. FINISH: 0.76μm MIN GOLD OVER 1.27μm MIN NICKEL REQUIRED ON INNER SURFACE, PERMITTED ON OUTER SURFACE.
- 2. FINISH: NICKEL BASE PLATE ON ALL SURFACES IN THIS AREA.
- 3. FINISH: 2.54μm MIN TIN-LEAD ON ALL SURFACES IN THIS AREA.
- 4. WIRE RANGE: (2) 0.8-0.9mm² (2 X 18 AWG)
(1) 1.2mm² (1 X 16 AWG)
- 5. INSULATION RANGE: 3.3 [.13] DIAMETER MAXIMUM FOR 2 X 18 AWG AND 3.0 [.12] DIAMETER FOR 1 X 16 AWG.
- 6. FINISH: 2.54μm MINIMUM TIN ON ALL SURFACES IN THIS AREA.

C

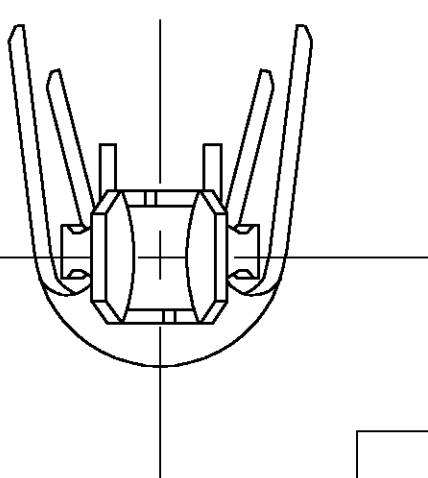
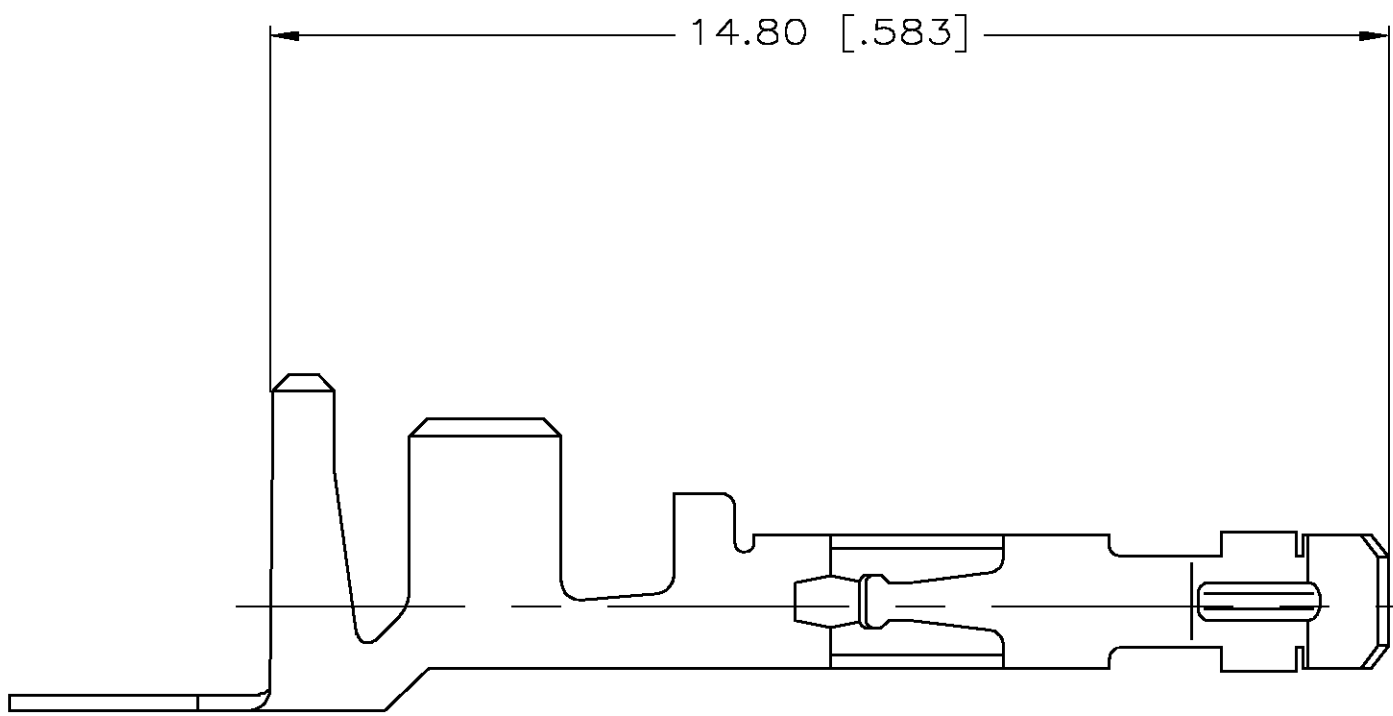

1-794143-3	1 2 6	0.22 [.009] PHOS BRONZE	1-794140-3
794143-3	1 2 3	0.22 [.009] PHOS BRONZE	794140-3
LOOSE PIECE (REF)	FINISH	MATERIAL	PART NUMBER

B

A



THIS DRAWING IS A CONTROLLED DOCUMENT.		DWN S. HOOVER 06-OCT-2004	Tyco Electronics Corporation Harrisburg, Pa 17105-3608	
DIMENSIONS: mm [INCHES]		CHK D. COLEY 06-OCT-2004	NAME CONTACT, SOCKET, AMP-DUAC™ POWER CONNECTOR	
TOLERANCES UNLESS OTHERWISE SPECIFIED: 0 PLC ± 1 PLC ± 2 PLC ± 0.10 3 PLC ± 4 PLC ± ANGLES ± FINISH		APVD D. COLEY 06-OCT-2004	PRODUCT SPEC	
MATERIAL SEE TABLE		APPLICATION SPEC	WEIGHT	
		CUSTOMER DRAWING	SIZE A2	CAGE CODE 00779
			DRAWING NO C=794140	RESTRICTED TO —
			SCALE 10:1	SHEET 1 OF 1
			REV G	