



Chipsmall Limited consists of a professional team with an average of over 10 year of expertise in the distribution of electronic components. Based in Hongkong, we have already established firm and mutual-benefit business relationships with customers from,Europe,America and south Asia,supplying obsolete and hard-to-find components to meet their specific needs.

With the principle of “Quality Parts,Customers Priority,Honest Operation,and Considerate Service”,our business mainly focus on the distribution of electronic components. Line cards we deal with include Microchip,ALPS,ROHM,Xilinx,Pulse,ON,Everlight and Freescale. Main products comprise IC,Modules,Potentiometer,IC Socket,Relay,Connector.Our parts cover such applications as commercial,industrial, and automotives areas.

We are looking forward to setting up business relationship with you and hope to provide you with the best service and solution. Let us make a better world for our industry!



Contact us

Tel: +86-755-8981 8866 Fax: +86-755-8427 6832

Email & Skype: info@chipsmall.com Web: www.chipsmall.com

Address: A1208, Overseas Decoration Building, #122 Zhenhua RD., Futian, Shenzhen, China



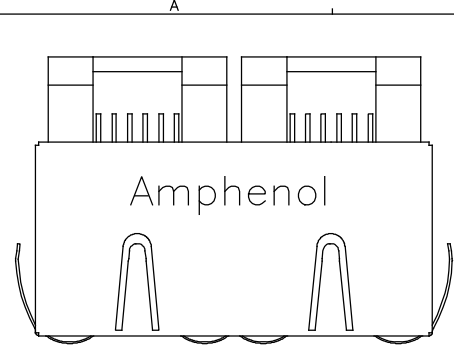

TOP VIEW

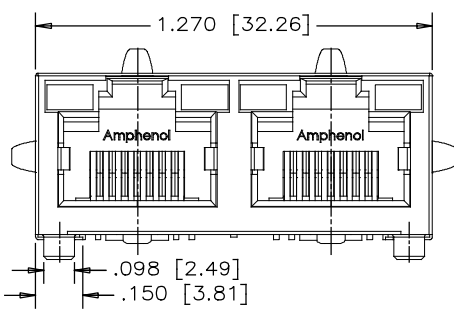

FRONT VIEW

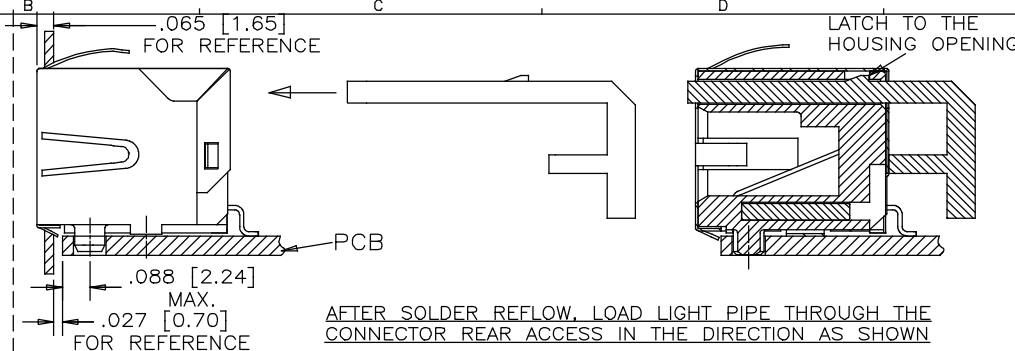

AFTER SOLDER REFLOW, LOAD LIGHT PIPE THROUGH THE CONNECTOR REAR ACCESS IN THE DIRECTION AS SHOWN

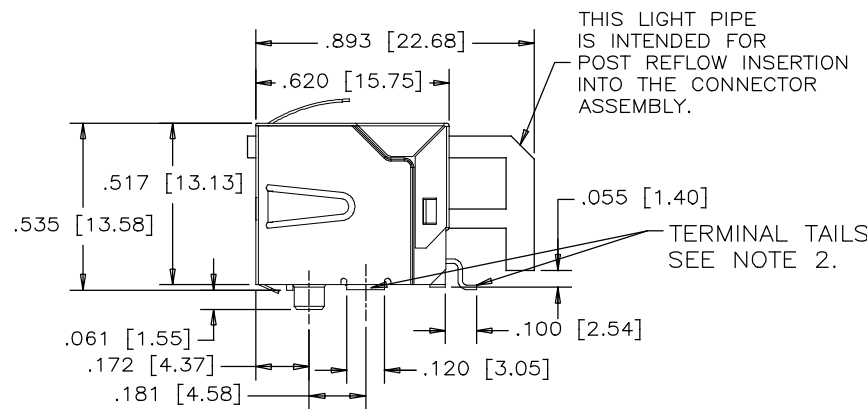

SIDE VIEW

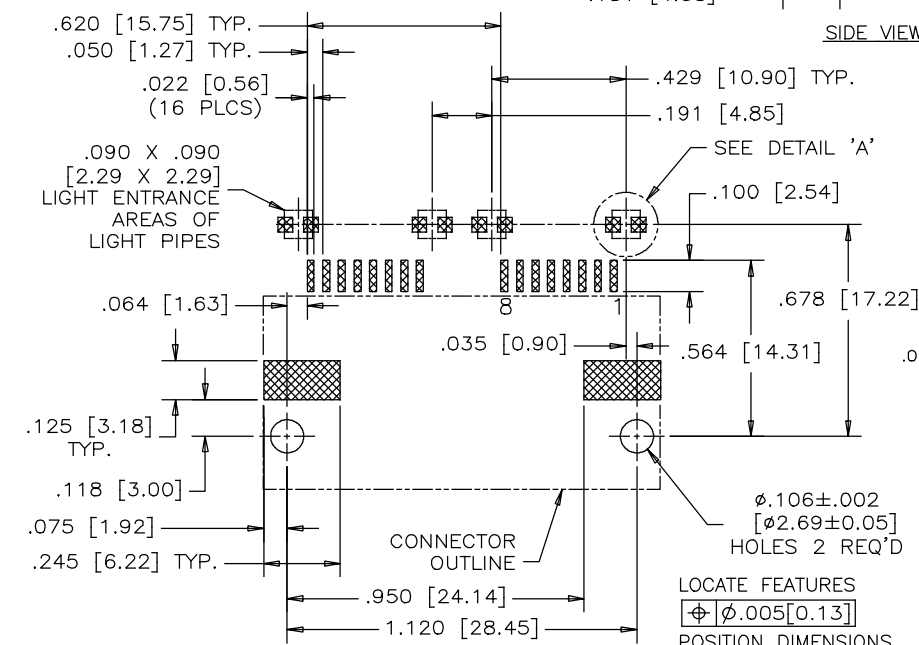

RECOMMENDED P.C.B. LAYOUT
(COMPONENT SIDE OF BOARD)

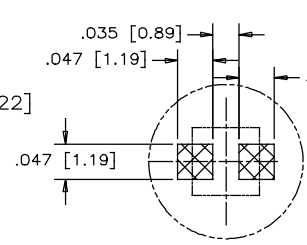

DETAIL 'A'
(ENLARGED)
SMT LED SOLDER PAD
(SMT LED TO BE PROVIDED BY THE CUSTOMER)

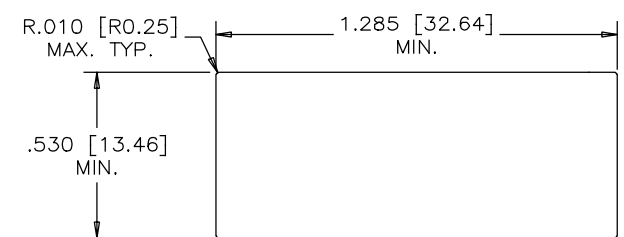

RECOMMENDED PANEL CUTOUT

REVISIONS				
SYM	ZONE	ECN, ERN NO.	DATE	APPRD.
A		PER ECN E07369	OCT18/07	L.C.
B		UPDATE DRAWING	NOV07/13	L.C.
C		CORRECT DIMENSION	JAN20/16	L.CHAN



1. MATERIALS:
HOUSING:

ENGINEERING THERMOPLASTIC
FLAMMABILITY RATING UL 94V-0
COLOR: BLACK

CONTACTS:
PLATING:

PHOSPHOR BRONZE
50 μ" [1.27 MICRONS] MIN. GOLD ON MATING SURFACES.
50 μ" [1.27 MICRONS] MIN. NICKEL UNDERPLATE.
100 μ" [2.54 MICRONS]
MIN. MATTE-TIN OR GOLD FLASH ON CONTACT TAILS.

SHIELD:

COPPER ALLOY PLATED TIN

LIGHT PIPE:

CLEAR POLYCARBONATE RATED UL 94V-0.

2. COPLANARITY SPECIFICATION:

WITH THE MODULAR JACK SITTING ON A LEVEL SURFACE,
THE MAXIMUM GAP BETWEEN THE LEVEL SURFACE OF SHIELD
TAB AND ALL TERMINAL TAILS IS .004 [0.10].

PART NUMBER: RJSSE-5381-02T

THIS DOCUMENT CONTAINS PROPRIETARY INFORMATION AND SUCH INFORMATION
MAY NOT BE DISCLOSED TO OTHERS FOR ANY PURPOSE OR USED FOR MANUFACTURING
PURPOSES WITHOUT WRITTEN PERMISSION FROM AMPHENOL CANADA CORP.

MATERIAL -----	DRAWN J.OU	DATE OCT18/07	Amphenol Canada Corp.		
	DESIGNED				
	CHECKED MT.CHAN	OCT18/07			
	I. E. APPRD. JEFF.S	OCT18/07			
FINISH -----	Q. A. APPRD. BORIS	OCT18/07	TITLE 2 PORT, SURFACE MOUNT, RJ45, MODULAR JACK, 8 POSITION, 8 CONTACTS, SHIELDED, LIGHT PIPES - ROHS COMPLIANT		
	DWG. APPRD.				
	ENG. REL. NO. E07369				
	REF. EAR A071008				
DIMENSIONS ARE IN INCHES [mm]		CODE ID. NO. 03554	DWG C	DRAWING NO. P-RJSSE-5381-02T	REV. C
		SCALE 3/1	WT. -----	SURF. -----	SHEET 1 OF 2

REVISIONS				
SYM	ZONE	ECN, ERN NO.	DATE	APPRD.
A		PER ECN E07369	OCT18/07	L.CHAN
B		UPDATE DRAWING	NOV07/13	L.CHAN
C		CORRECT DIMENSION	JAN20/16	L.CHAN

.728±.010
[18.5±0.25]

.0157±.002
[0.40±0.05]

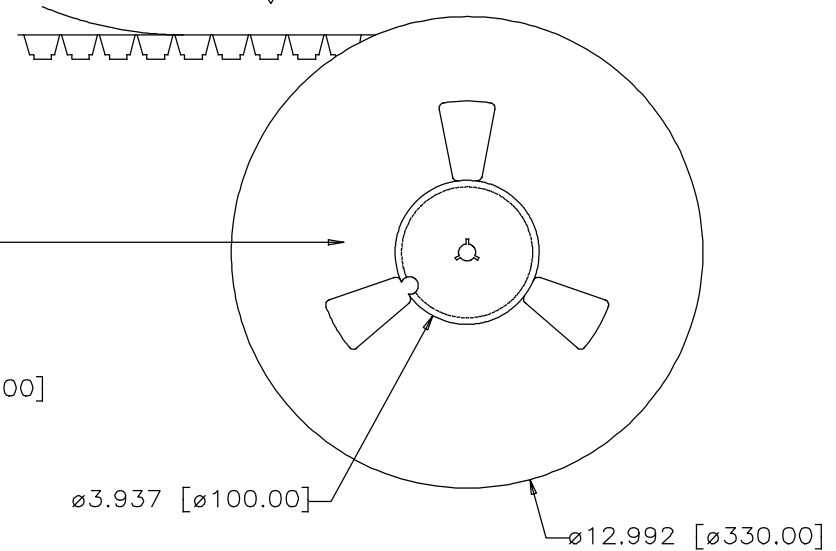
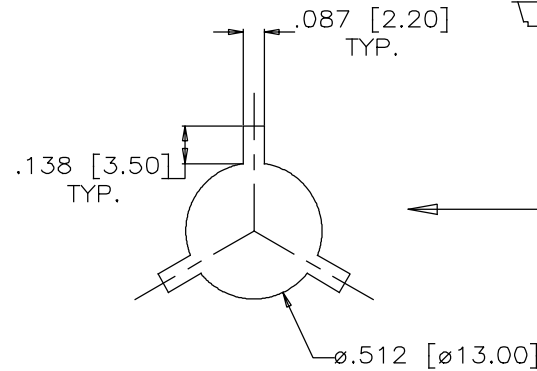
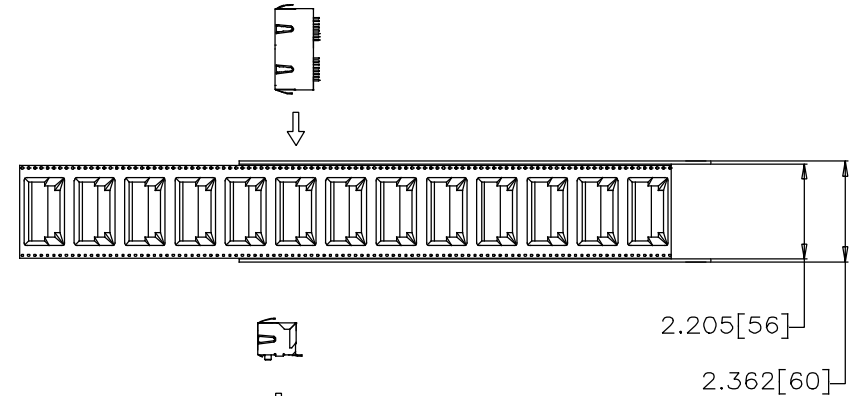
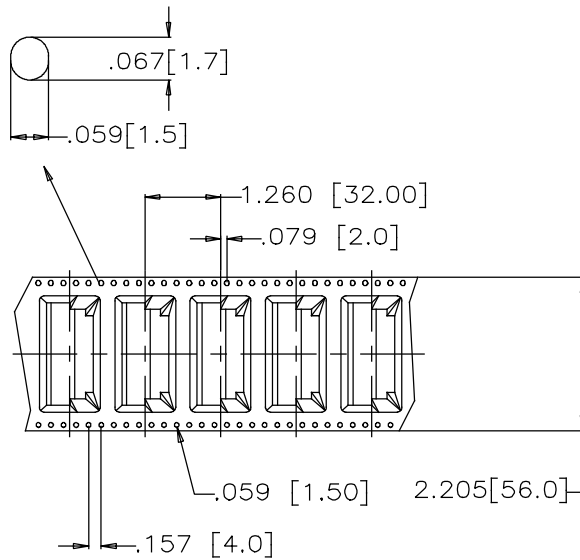

PACKAGING NOTES:

1. ONE REEL SHOULD HOLD 100 CONNECTORS.
2. 10 EMPTY CAVITIES FOR BOTH TOP AND BOTTOM OF THE CARRIER.
3. A FULLY LOADED CARTON SHOULD CONTAIN 3 REELS (300 PCS) OF CONNECTOR.
4. LIGHT PIPES WILL BE PACKED IN SEPARATE TRAYS

THIS DOCUMENT CONTAINS PROPRIETARY INFORMATION AND SUCH INFORMATION MAY NOT BE DISCLOSED TO OTHERS FOR ANY PURPOSE OR USED FOR MANUFACTURING PURPOSES WITHOUT WRITTEN PERMISSION FROM AMPHENOL CANADA CORP.

MATERIAL -----	DRAWN	J.OU	DATE	OCT18/07	Amphenol Canada Corp. TITLE 2 PORT, SURFACE MOUNT, RJ45 ,MODULAR JACK, 8 POSITION, 8 CONTACTS,SHIELDED, LIGHT PIPES -ROHS COMPLIANT DWG. APPRD. C			
	DESIGNED							
	CHECKED	MT.CHAN	OCT18/07					
	I. E. APPRD.	JEFF.S	OCT18/07					
	Q. A. APPRD.	BORIS	OCT18/07					
FINISH -----	ENG. REL. NO.	E07369			DWG	DRAWING NO.	P-RJSSE-5381-02T	REV.
	REF.	EAR A071008			C			C
	DIMENSIONS ARE IN	CODE ID. NO.			SCALE	WT.	SURF.	SHEET 2 OF 2
	INCHES [mm]	03554						