



Chipsmall Limited consists of a professional team with an average of over 10 year of expertise in the distribution of electronic components. Based in Hongkong, we have already established firm and mutual-benefit business relationships with customers from,Europe,America and south Asia,supplying obsolete and hard-to-find components to meet their specific needs.

With the principle of “Quality Parts,Customers Priority,Honest Operation,and Considerate Service”,our business mainly focus on the distribution of electronic components. Line cards we deal with include Microchip,ALPS,ROHM,Xilinx,Pulse,ON,Everlight and Freescale. Main products comprise IC,Modules,Potentiometer,IC Socket,Relay,Connector.Our parts cover such applications as commercial,industrial, and automotives areas.

We are looking forward to setting up business relationship with you and hope to provide you with the best service and solution. Let us make a better world for our industry!



Contact us

Tel: +86-755-8981 8866 Fax: +86-755-8427 6832

Email & Skype: info@chipsmall.com Web: www.chipsmall.com

Address: A1208, Overseas Decoration Building, #122 Zhenhua RD., Futian, Shenzhen, China



4

3

2

1

THIS DRAWING IS UNPUBLISHED.

RELEASED FOR PUBLICATION

20

(C) COPYRIGHT 20

BY TYCO ELECTRONICS CORPORATION. ALL RIGHTS RESERVED.

LOC
DSDIST
-

REVISIONS

P	LTR	DESCRIPTION	DATE	DWN	APVD
B		REVISED (ECR-07-005158)	14.MAR'07	SC	JK
C		REVISED (ECR-09-011788)	25.MAY'09	SC	JK
C1		REVISED (ECR-13-016595)	25.OCT'13	KD	BW

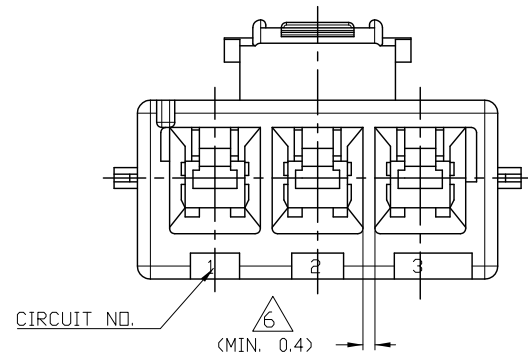
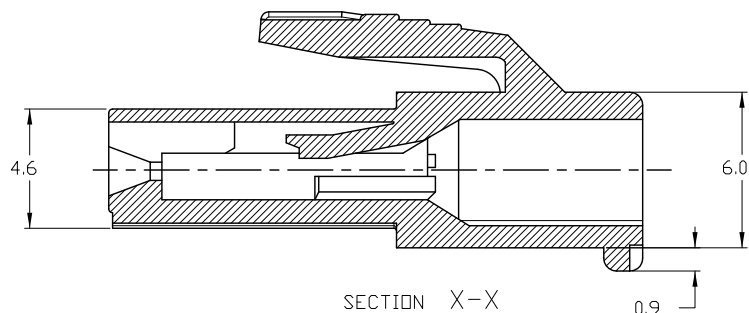
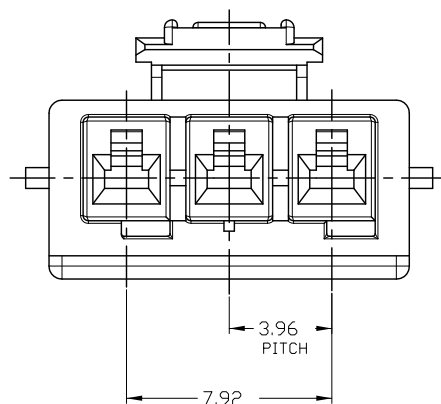
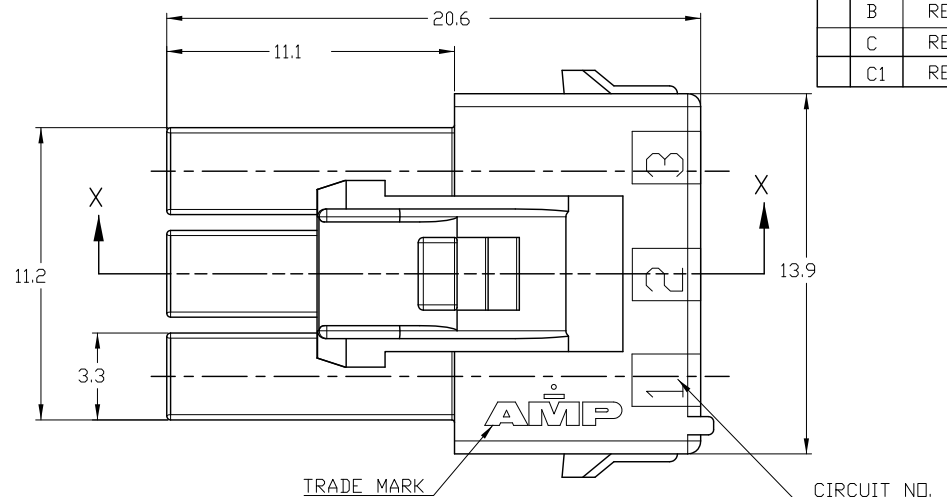

NOTE:

1.APPLICABLE CONTACT P/N

-REC CONTACT:177915- □(AWG#16-#20)

:177914- □(AWG#22-#26)

2.MATING CONN.P/N

-CAP HSG:368572- □(FREE HANGING)

2005250- □(PANEL MOUNT)

-TAB CONTACT:177917- □(AWG#16-#20)

177916- □(AWG#22-#26)

-PC BOARD MOUNT(ASS'Y):179839- □

3.APPLICABLE DOUBLE LOCK PLATE:177919-1

*IT SHOULD BE USED CERTAINLY WHEN CABLE ASS'Y

4.GENERAL TOLERANCES:±0.3

5.ACCORDING TO IEC 60335-1 4.2 EDITION

-PART MEETS GWT 750°C,850°C.

-MATERIAL MEETS BALL PRESSURE TESTING AT 125°C.

-MATERIAL HAS CTI VALUE OF 250V.

6.MIN.THICKNESS OF INSULATING WALL

THIS DRAWING IS A CONTROLLED DOCUMENT FOR TYCO ELECTRONICS CORPORATION
IT IS SUBJECT TO CHANGE AND THE CONTROLLING ENGINEERING ORGANIZATION
SHOULD BE CONTACTED FOR THE LATEST REVISION.

DIMENSIONS:	TOLERANCES UNLESS OTHERWISE SPECIFIED
mm	
	0 PLC ±
	1 PLC ±0.5
	2 PLC ±0.13
	3 PLC ±0.013
	4 PLC ±0.0001
	ANGLES ±
MATERIAL	FINISH
PA66(UL94V-0)	-

DWN
KD CHEONCHK
BH CHOAPVD
BW KANG

PRODUCT SPEC

108-61106

APPLICATION SPEC

-

WEIGHT

-

CUSTOMER DRAWING



TE Connectivity

NAME

PDL 3P PLUG HSG 3.96mm (GWT)

SIZE

CAGE CODE

DRAWING NO

368571

RESTRICTED TO

-

SCALE

5:1

SHEET

1

OF

1

REV

C1