



Chipsmall Limited consists of a professional team with an average of over 10 year of expertise in the distribution of electronic components. Based in Hongkong, we have already established firm and mutual-benefit business relationships with customers from,Europe,America and south Asia,supplying obsolete and hard-to-find components to meet their specific needs.

With the principle of “Quality Parts,Customers Priority,Honest Operation,and Considerate Service”,our business mainly focus on the distribution of electronic components. Line cards we deal with include Microchip,ALPS,ROHM,Xilinx,Pulse,ON,Everlight and Freescale. Main products comprise IC,Modules,Potentiometer,IC Socket,Relay,Connector.Our parts cover such applications as commercial,industrial, and automotives areas.

We are looking forward to setting up business relationship with you and hope to provide you with the best service and solution. Let us make a better world for our industry!



## Contact us

Tel: +86-755-8981 8866 Fax: +86-755-8427 6832

Email & Skype: [info@chipsmall.com](mailto:info@chipsmall.com) Web: [www.chipsmall.com](http://www.chipsmall.com)

Address: A1208, Overseas Decoration Building, #122 Zhenhua RD., Futian, Shenzhen, China



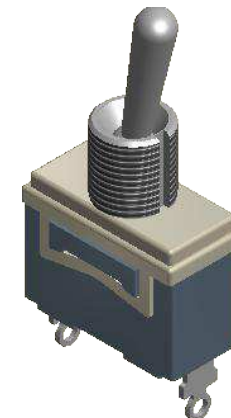
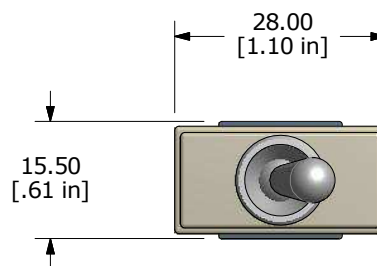
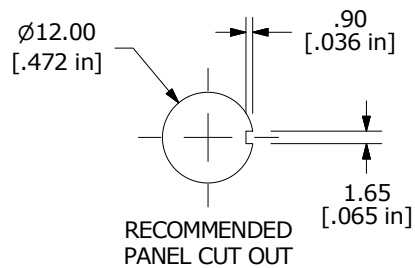

▲ SWITCH FUNCTION		
POS. 1	POS. 2	POS. 3
OFF	N/A	ON
NONE	N/A	1-3

## NOTES:

- ALL DIMENSIONS IN MM
- GENERAL TOLERANCE: X.X =  $\pm 0.4$   
X.XX =  $\pm 0.25$
- TERM. NOS. FOR REFERENCE ONLY
- ELECTRICAL LIFE: 6,000 CYCLES
- OPERATING TEMP: -20°C to 85°C
- CONTACT RESISTANCE: 50m $\Omega$  MAX. INITIAL
- INSULATION RESISTANCE: 800M $\Omega$  AT 500VDC
- DIELECTRIC STRENGTH: 1500VAC FOR 1 MINUTE
- 2011/65/EU (ROHS) COMPLIANT
- ▲ DENOTES CRITICAL PARAMETER
- CONTACT RATING: 20A 125VAC,  
15A 277VAC  
2HP 125/277VAC  
cULus (E194579)

▲ 10. SUPPLIED HARDWARE: 2 HEXNUTS

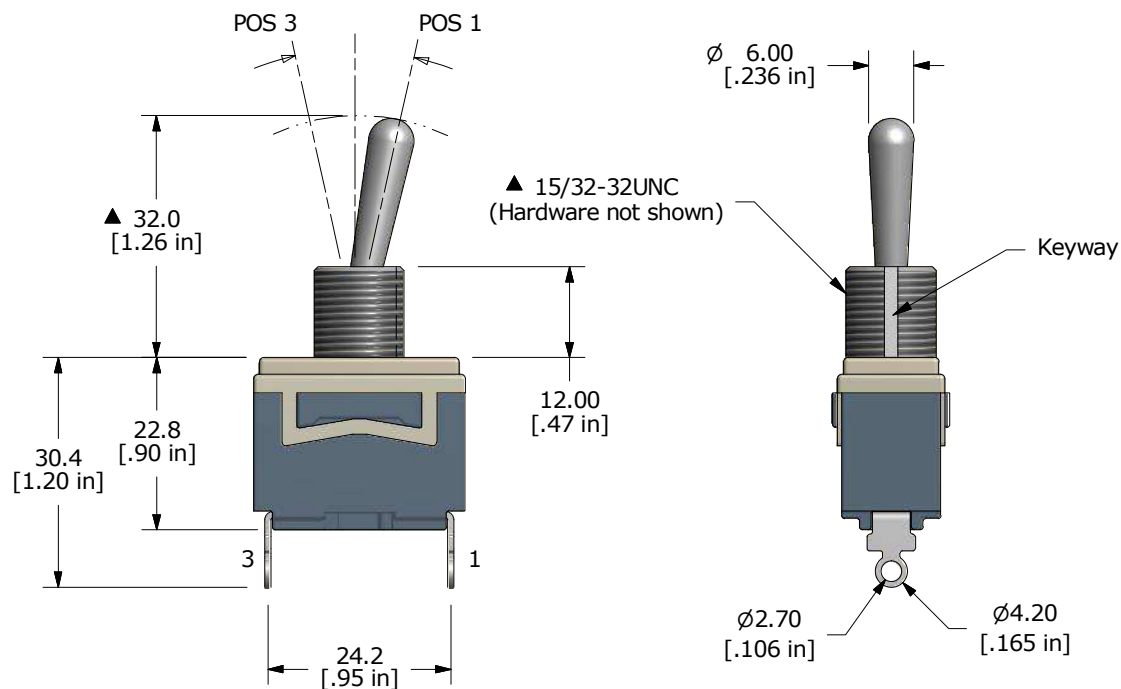

B	22956	correct notes 9 and 10	8/11/17	MW
A	22907	Initial Release	6/23/17	MW
REV	PCR NO	DESCRIPTION	DATE	BY

THE INFORMATION CONTAINED IN THIS DOCUMENT IS PROPRIETARY  
TO E-SWITCH AND IS NOT TO BE COPIED OR TRANSFERRED

TITLE ST121D02

SCALE 1:1

DATE 6/19/2017

DR MW

DWG 34-ST121D02

REV B