

REV.	DESCRIPTION	DATE
A	RELEASE	2016.05.14

RoHS

MATERIAL&FINISH

Insulator: PBT Glass Fiber(UL94V-0)
 Contact Material: Terminal Brass.
 Contact Plating : Terminal Shell
 Shell Spec. Gold-Plated Over Nickel.
 Shell Nickel.

SPECIFICATIONS

Current Rating :1A AC, DC
 Voltage Rating : 250V AC, DC
 Temperature Range:-40° C To+105° C
 Contact Resistance:20MΩ Max
 Insulation Resistance:1000MΩ Min
 Withstanding Voltage:500V AC/Min

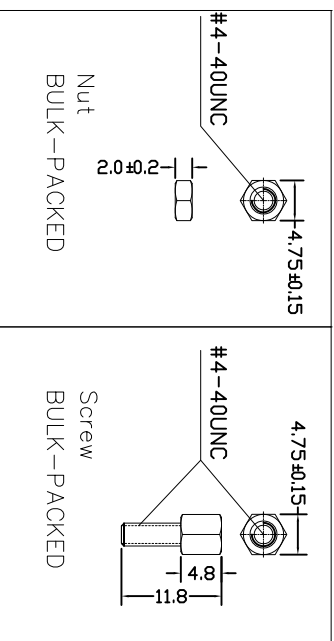
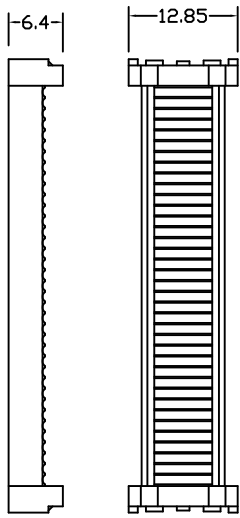
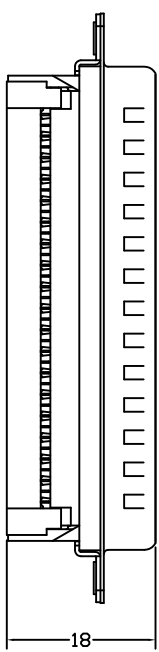
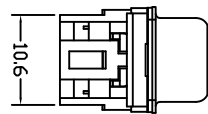
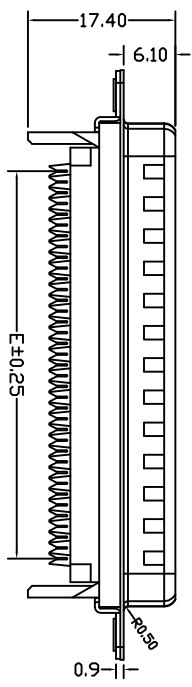
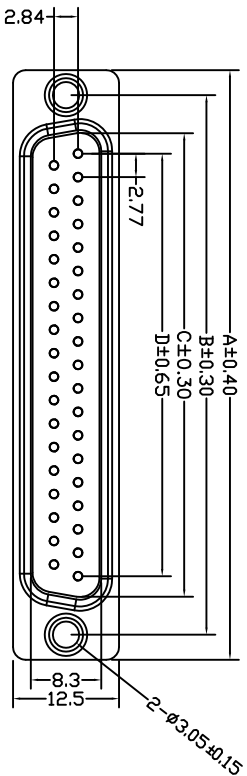

NUMBER OF POSITIONS	DIMENSION				
	A	B	C	D	E
9	30.80	25.00	16.95	11.08	10.16
15	39.14	33.30	25.3	19.39	17.78
25	53.05	47.04	38.96	33.24	30.48
37	69.32	63.50	55.42	49.86	45.72

UNLESS TOLERANCE

GENERAL	ANGLE	DRAW BY
X. ± 0.30	X°. ± 3.0°	DESIGN BY
.X ± 0.20	.X° ± 2.0°	CHECK BY
.XX ± 0.15	.XX° ± 1.0°	APPROVE BY
.XXX ± 0.08	.XXX ± 0.5°	

SCALE	SHEET	UNIT
1:1	1/1	MM

CnC Tech,LLC

Part NO.
400M0-XX-1-00

DRW NO: _____ REV: A