



Chipsmall Limited consists of a professional team with an average of over 10 year of expertise in the distribution of electronic components. Based in Hongkong, we have already established firm and mutual-benefit business relationships with customers from,Europe,America and south Asia,supplying obsolete and hard-to-find components to meet their specific needs.

With the principle of “Quality Parts,Customers Priority,Honest Operation,and Considerate Service”,our business mainly focus on the distribution of electronic components. Line cards we deal with include Microchip,ALPS,ROHM,Xilinx,Pulse,ON,Everlight and Freescale. Main products comprise IC,Modules,Potentiometer,IC Socket,Relay,Connector.Our parts cover such applications as commercial,industrial, and automotives areas.

We are looking forward to setting up business relationship with you and hope to provide you with the best service and solution. Let us make a better world for our industry!



Contact us

Tel: +86-755-8981 8866 Fax: +86-755-8427 6832

Email & Skype: info@chipsmall.com Web: www.chipsmall.com

Address: A1208, Overseas Decoration Building, #122 Zhenhua RD., Futian, Shenzhen, China



Customer Information Sheet

DRAWING No.: M30-600XX46R SHEET 3 OF 4 IF IN DOUBT - ASK (C) NOT TO SCALE THIRD ANGLE PROJECTION ALL DIMENSIONS IN mm

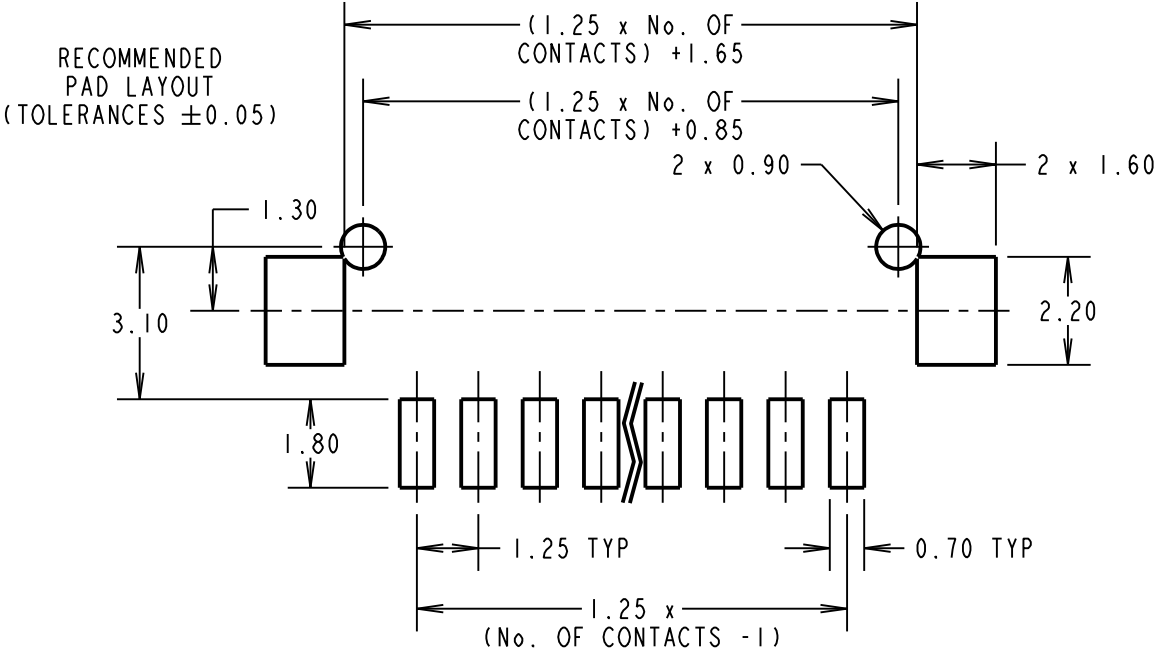
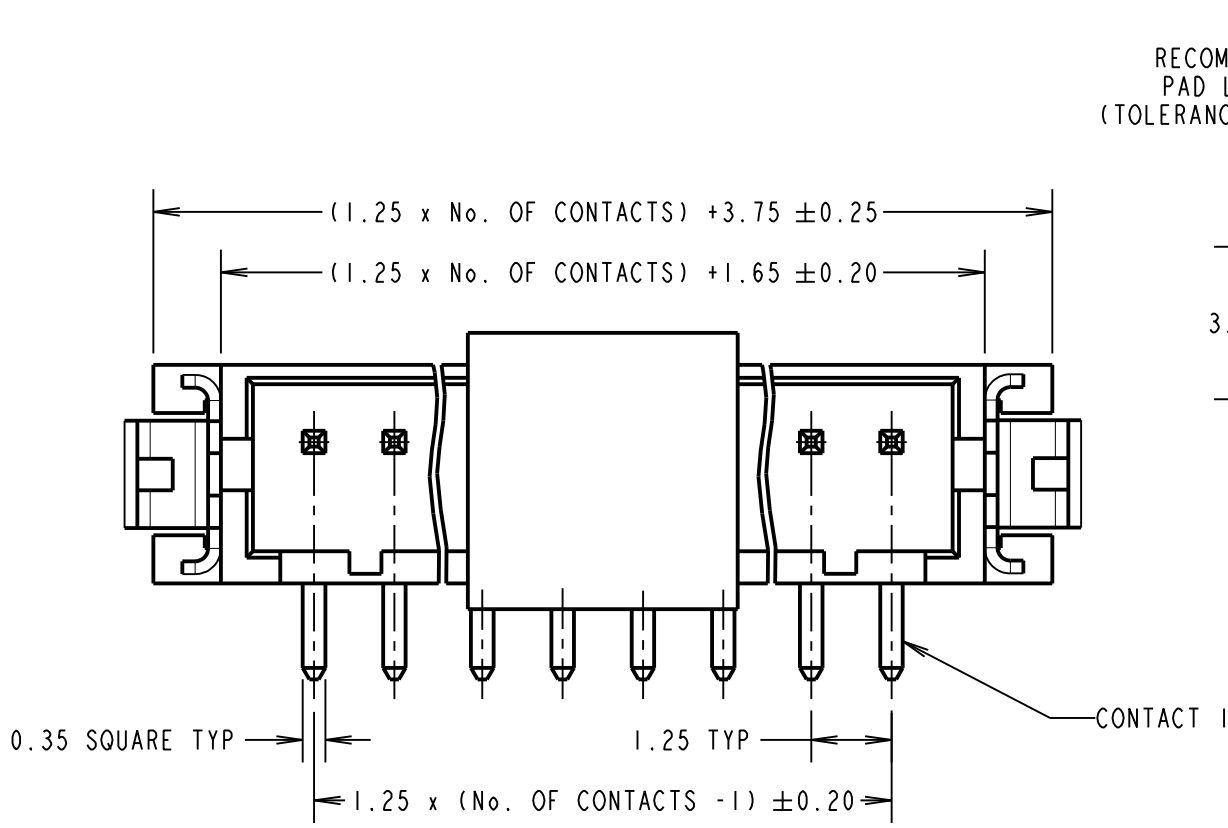

SPECIFICATIONS:
MATERIAL:
MOULDING = NYLON 6T NATURAL, UL94V-0
CONTACT = BRASS
RETAINER = PHOSPHOR BRONZE
FINISH:
CONTACT = 2.03µ - 2.54µ 100% TIN OVER 0.76µ NICKEL
RETAINER = 2.03µ - 2.54µ 100% TIN OVER 0.76µ NICKEL
ELECTRICAL:
CURRENT RATING = 1A AC/DC
VOLTAGE RATING = 150V AC/DC
CONTACT RESISTANCE = 30mΩ MAX
INSULATION RESISTANCE = 500 MΩ MIN
DIELECTRIC WITHSTANDING VOLTAGE = 500V AC FOR ONE MINUTE
ENVIRONMENTAL:
TEMPERATURE RANGE = -25° TO +85°C
PACKING: TAPE AND REEL
FOR COMPLETE SPECIFICATION, SEE COMPONENT SPECIFICATION C025XX (LATEST ISSUE)

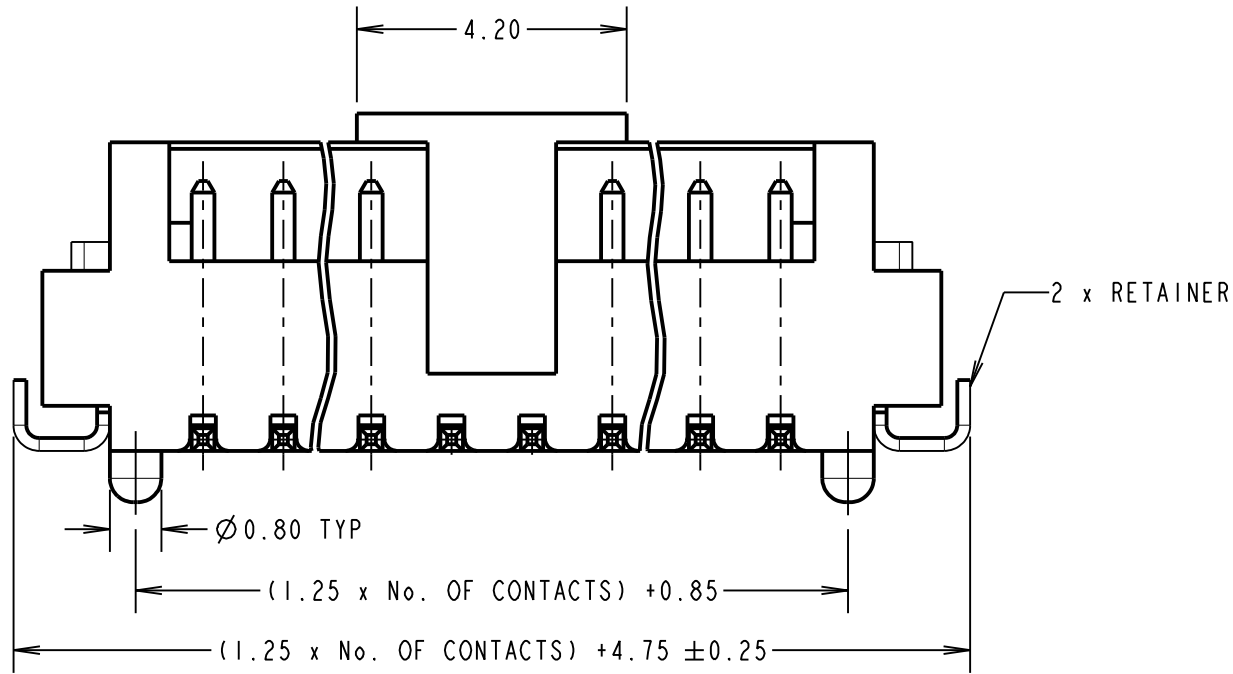
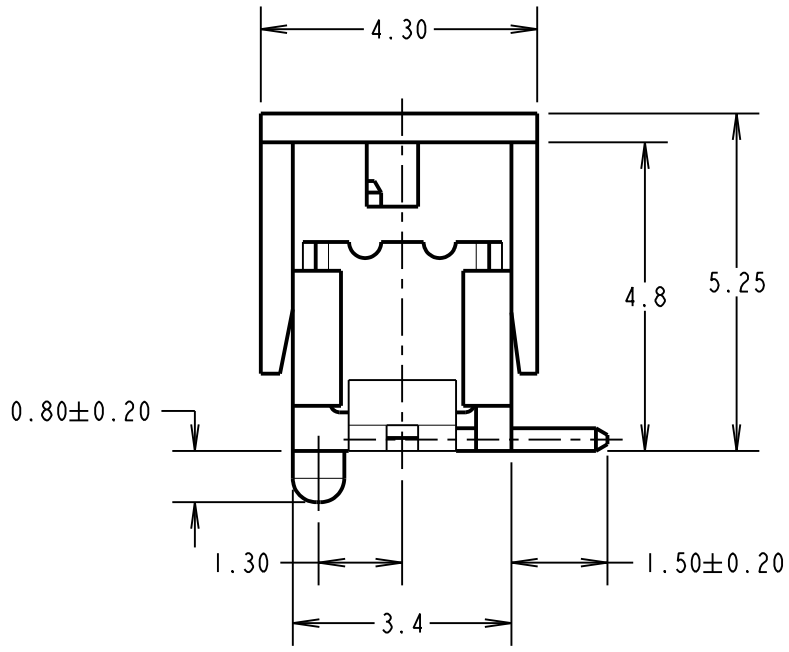

ORDER CODE:
M30-600XX46R
No. OF CONTACTS
02 TO 15
FINISH:
46 = 100% TIN

SB	7	17.09.12	11801
NAME	ISS.	DATE	C/NOTE
APPROVED: S.BENNETT			
CHECKED: S.FLOWER			
DRAWN: JM BROOKES			
CUSTOMER REF.:			
ASSEMBLY DRG:			

- NOTES:
1. FOR REELING DETAILS SEE PAGE 4.
2. MATES WITH M30-1050046 AND M30-1060046 CRIMP CONTACTS.
MATES WITH M30-110XX00 CRIMP MOULDING.
3. COPLANARITY OF CONTACTS AND RETAINER TO BE 0.1mm MAX.

HARWIN
www.harwin.com
technical@harwin.com

THIS DRAWING AND ANY INFORMATION OR DESCRIPTIVE MATTER SET OUT HEREON ARE CONFIDENTIAL AND COPYRIGHT PROPERTY OF THE HARWIN GROUP AND MUST NOT BE DISCLOSED, LOANED, COPIED OR USED FOR MANUFACTURING, TENDERING OR FOR ANY OTHER PURPOSE WITHOUT THEIR WRITTEN PERMISSION.

TOLERANCES
X. = ± 1mm
X.X = ± 0.50mm
X.XX = ± 0.10mm
X.XXX = ± 0.01mm
ANGLES = ± 5°
UNLESS STATED

MATERIAL:
SEE ABOVE
FINISH: SEE ABOVE
S/AREA: mm²

TITLE: 1.25mm PITCH SIL SMT BOARD MOUNT CONNECTOR (TAPE AND REEL)
DRAWING NUMBER: **M30-600XX46R**
SHT 3 OF 4

Customer Information Sheet

DRAWING No.: M30-600XX46R

SHEET 4 OF 4

IF IN DOUBT - ASK

©

NOT TO SCALE

THIRD ANGLE PROJECTION

ALL DIMENSIONS IN mm

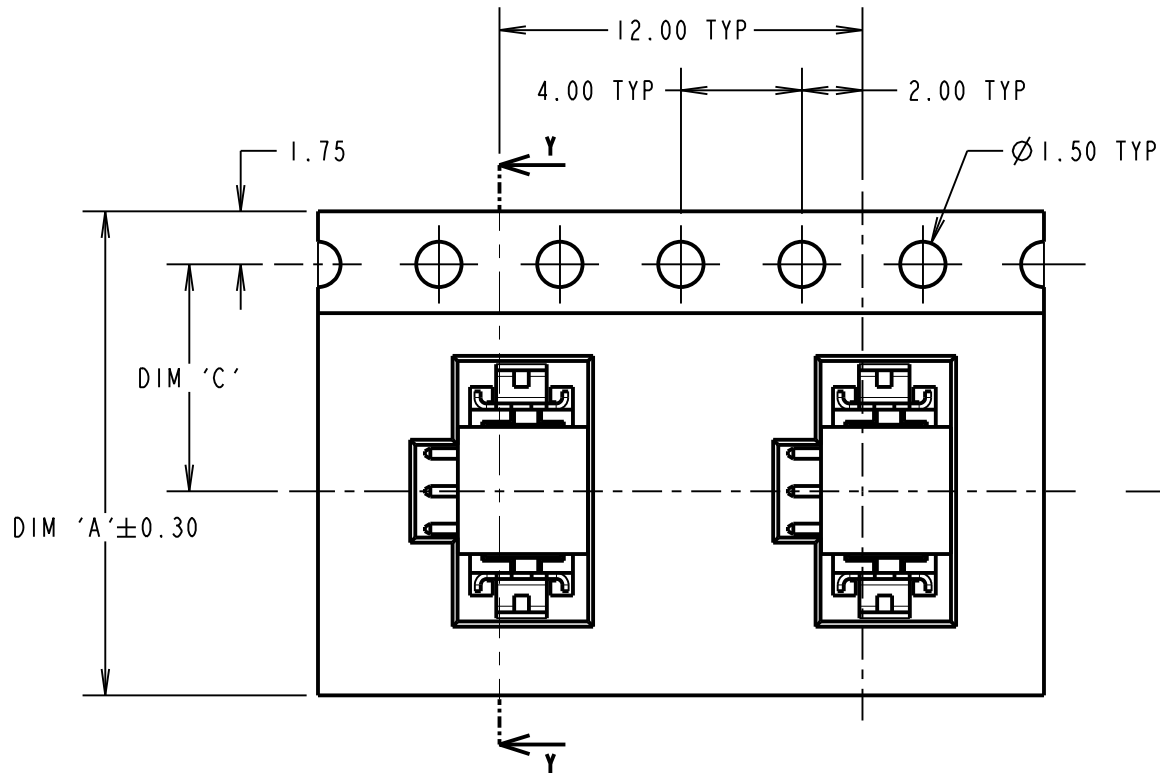

TAPE DETAILS FOR
2 TO 9 CONTACTS

TAPE
DIRECTION

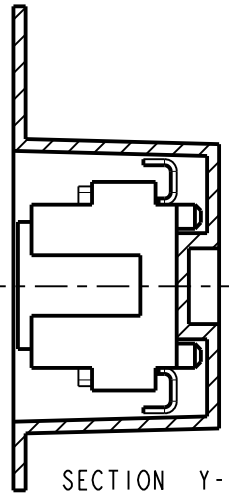

SECTION Y-Y

No. OF WAYS	DIM 'A'	DIM 'B'	DIM 'C'	QTY/REEL
2	16	---	7.5	1000
3	16	---	7.5	1000
4	24	---	11.5	1000
5	24	---	11.5	1000
6	24	---	11.5	1000
7	24	---	11.5	1000
8	24	---	11.5	1000
9	24	---	11.5	1000
10	32	28.4	14.2	1000
11	32	28.4	14.2	1000
12	32	28.4	14.2	1000
13	32	28.4	14.2	1000
14	32	28.4	14.2	1000
15	32	28.4	14.2	1000

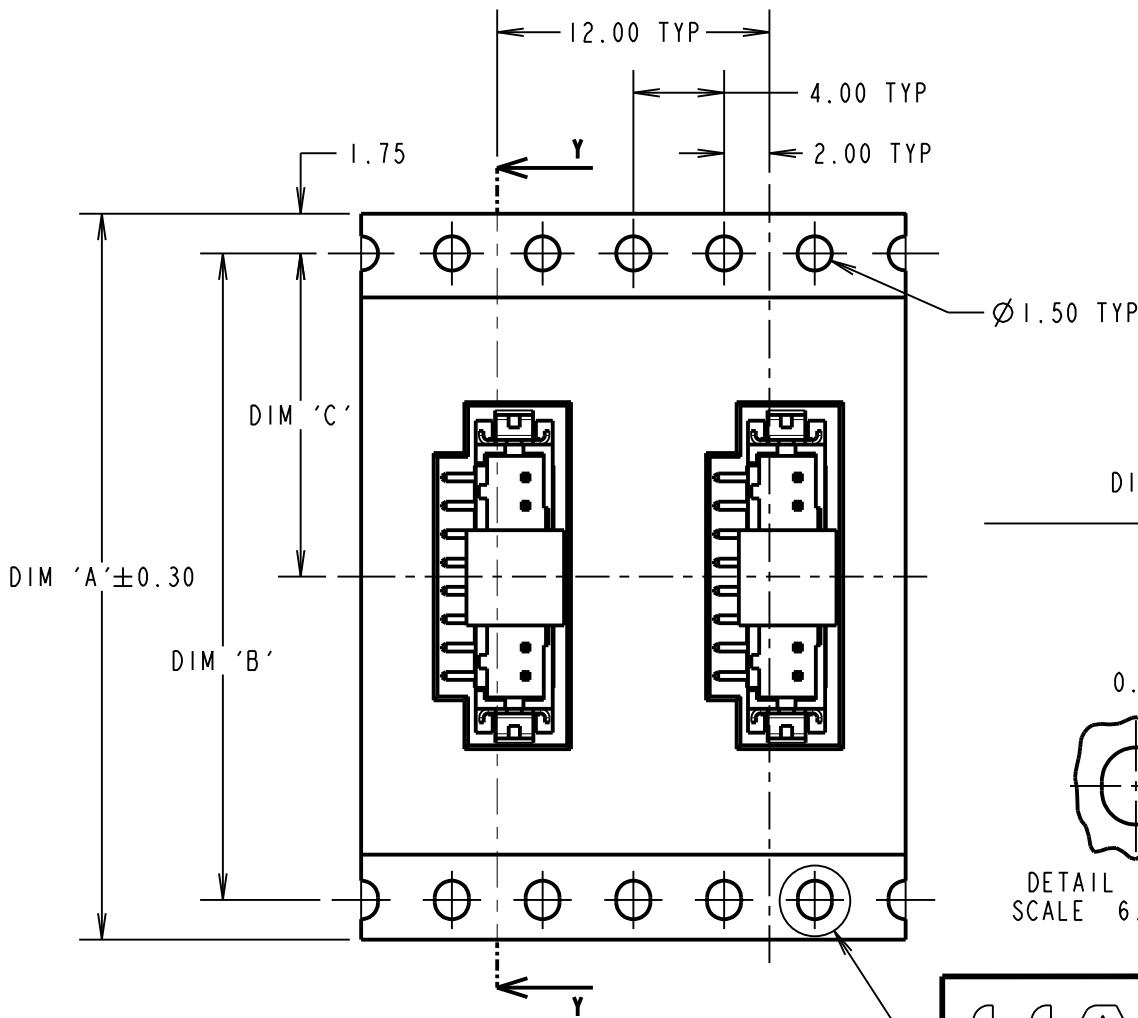

TAPE DETAILS FOR
10 TO 15 CONTACTS

TAPE
DIRECTION

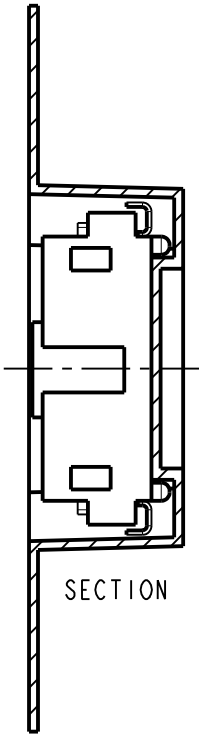

SECTION Y-Y

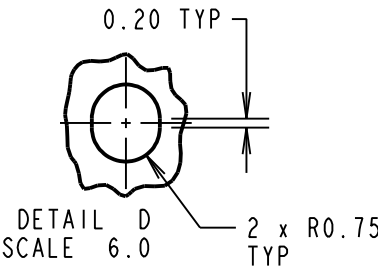

SEE DETAIL D

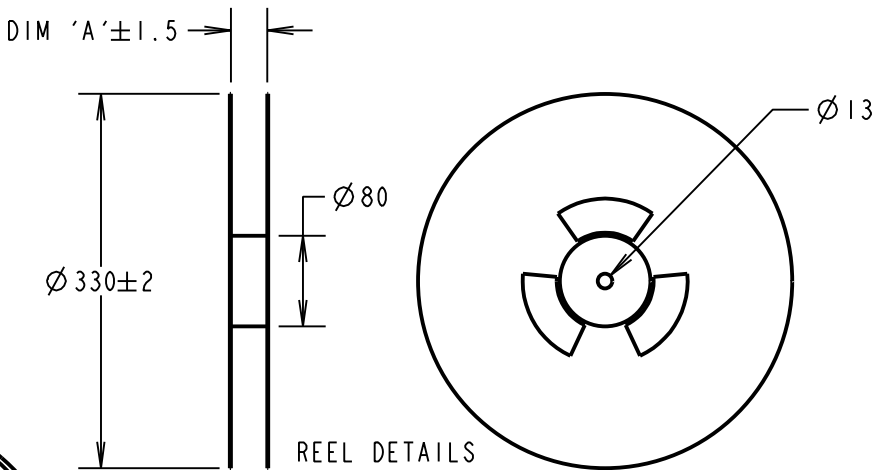

REEL DETAILS

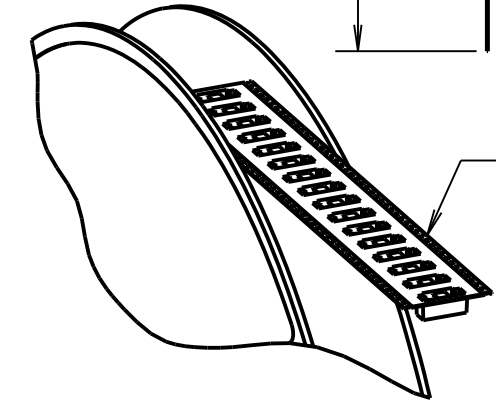

ROUND HOLES THIS SIDE

- NOTES:
1. FOR CONNECTOR DIMENSIONS, SEE SHEET 3.
2. ALL TOLERANCES ARE ± 0.15 UNLESS OTHERWISE STATED.

SB	7	17.09.12	11801
NAME	ISS.	DATE	C/NOTE
APPROVED: S.BENNETT			
CHECKED: S.FLOWER			
DRAWN: JM BROOKES			
CUSTOMER REF.:			
ASSEMBLY DRG:			

HARWIN

www.harwin.com
technical@harwin.com

THIS DRAWING AND ANY
INFORMATION OR DESCRIPTIVE
MATTER SET OUT HEREON ARE
CONFIDENTIAL AND COPYRIGHT
PROPERTY OF THE HARWIN
GROUP AND MUST NOT BE
DISCLOSED, LOANED, COPIED
OR USED FOR MANUFACTURING,
TENDERING OR FOR ANY
OTHER PURPOSE WITHOUT
THEIR WRITTEN PERMISSION.

TOLERANCES
X. = $\pm 1\text{mm}$
X.X = $\pm 0.50\text{mm}$
X.XX = $\pm 0.10\text{mm}$
X.XXX = $\pm 0.01\text{mm}$
ANGLES = $\pm 5^\circ$
UNLESS STATED

MATERIAL:

SEE SHEET 3

FINISH:

SEE SHEET 3

S/AREA:

mm²

TITLE: 1.25mm PITCH SIL
SMT BOARD MOUNT CONNECTOR
(TAPE AND REEL)

DRAWING NUMBER:

M30-600XX46R

SHT
4 OF 4