

DO NOT SCALE

METRIC

THIRD ANGLE
PROJECTION

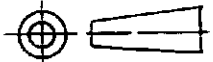

DIMENSIONS IN mm

LTR.	REVISION RECORD	DR.	CHK.	DATE
B1	ECO-09-026346	KK	AEG	26NOV09

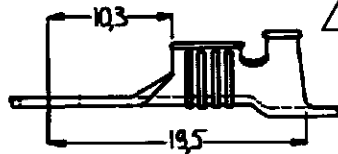
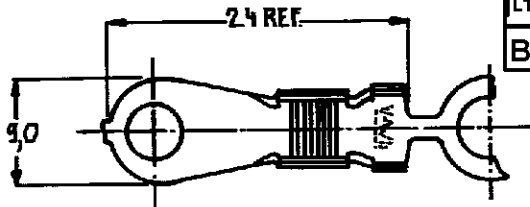

5 OBSOLETE PARTS: OBSOLETE CIS
STREAMLINING PER D.RENAUD/D.SINISI

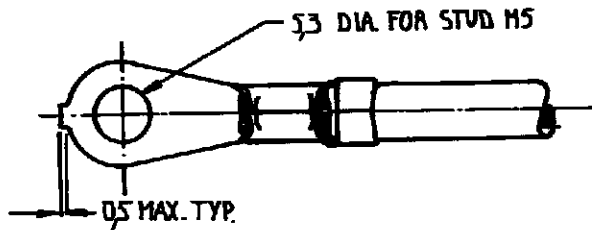

DOC. CENTRE
14 JUNI 1993

NOTES: Δ FOR USE ON STANDARD AND MINIATURE APPLICATORS

Δ FOR USE ON MINIATURE APPLICATORS. (AMP-O-MATOR APPLICATION)

Δ WITH PAPER COVER

Δ WITH PAPER LAYER

NOTES	FINISH	MATERIAL	PART NUMBER
Δ OBSOLETE	Δ UNPLATED	PHOSPHOR BRONZE	160134-7
	Δ TINPLATED	PHOSPHOR BRONZE	160134-6
	Δ UNPLATED	PHOSPHOR BRONZE	160134-5
Δ OBSOLETE	Δ UNPLATED	BRASS	160134-4
	Δ UNPLATED	PHOSPHOR BRONZE	160134-3
	Δ TINPLATED	BRASS	160134-2
	Δ UNPLATED	BRASS	160134-1

**CUSTOMER
DRAWING**

FOR REFERENCE ONLY
WILL NOT BE UPDATED

AMP

AMP-HOLLAND B.V.
's-Hertogenbosch, The Netherlands

THIS DRAWING IS UNPUBLISHED

RELEASED FOR PUBLICATION

12

© COPYRIGHT 19 BY AMP-HOLLAND B.V.
ALL INTERNATIONAL RIGHTS RESERVED.
AMP PRODUCTS MAY BE COVERED BY U.S. AND FOREIGN PATENTS AND/OR PATENTS PENDING.

DR. 21/83	WIRE RANGE 3,1 - 5,3 mm ²	NAME RINGTONGUE WITH INSULATION SUPPORT	REV. DATE D M Y
CHK. 24/83	INSUL. RANGE 3,8 - 5,3 DIA.		26 11 09
APP. 22.1.83	SIZE A4	SHEET 1 OF 1	DRAWING NO C-160134
			REV. LTR. B1