



Chipsmall Limited consists of a professional team with an average of over 10 year of expertise in the distribution of electronic components. Based in Hongkong, we have already established firm and mutual-benefit business relationships with customers from,Europe,America and south Asia,supplying obsolete and hard-to-find components to meet their specific needs.

With the principle of “Quality Parts,Customers Priority,Honest Operation,and Considerate Service”,our business mainly focus on the distribution of electronic components. Line cards we deal with include Microchip,ALPS,ROHM,Xilinx,Pulse,ON,Everlight and Freescale. Main products comprise IC,Modules,Potentiometer,IC Socket,Relay,Connector.Our parts cover such applications as commercial,industrial, and automotives areas.

We are looking forward to setting up business relationship with you and hope to provide you with the best service and solution. Let us make a better world for our industry!



Contact us

Tel: +86-755-8981 8866 Fax: +86-755-8427 6832

Email & Skype: info@chipsmall.com Web: www.chipsmall.com

Address: A1208, Overseas Decoration Building, #122 Zhenhua RD., Futian, Shenzhen, China



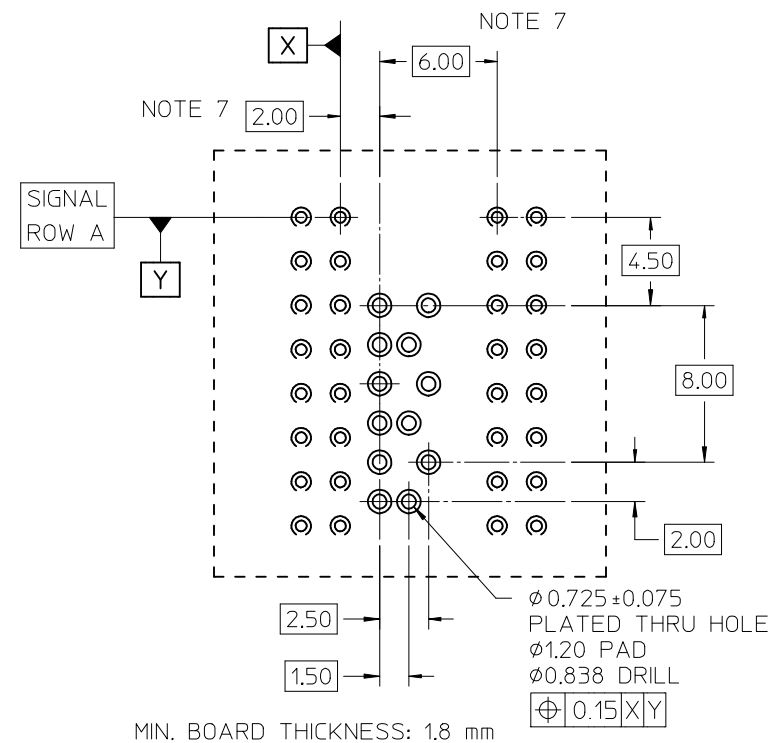
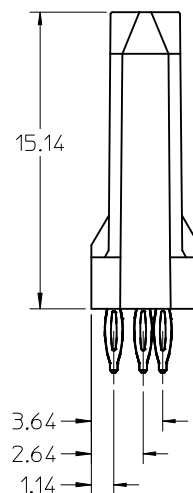
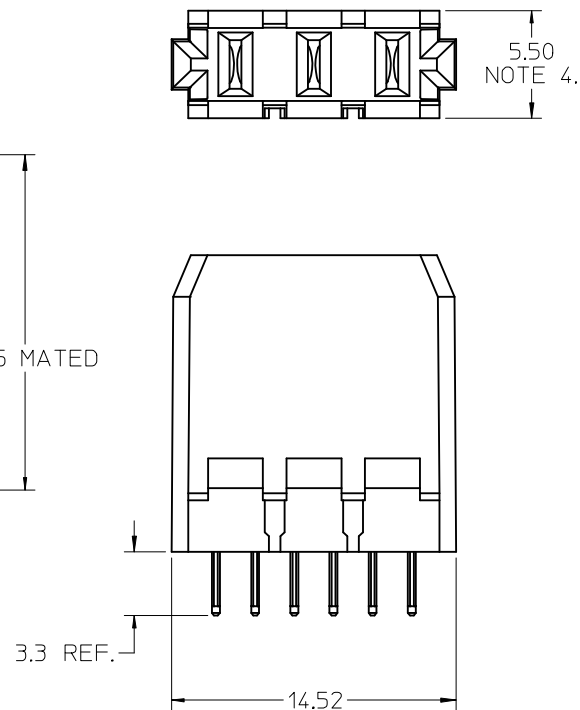

1. MATERIALS:
HOUSING - LIQUID CRYSTAL POLYMER (LCP)
UL94 V-0 RATED, COLOR: BLACK
TERMINAL - COPPER ALLOY
2. FINISH: 30 microINCH MIN GOLD ON MATING SURFACE;
MATTE TIN ON TAILS; NICKEL OVERALL.
3. THIS PART CONFORMS TO PRODUCT SPECIFICATION
PS-74031-999.
4. USE 6.00 mm NOMINAL FOR BACKPLANE LAYOUT.
5. DIMENSION MEASURED FROM BOTTOM OF HOUSING.
6. PACKED PER PK-70873-0876.
7. THIS DIMENSION TO BE MULTIPLE OF 2.00 mm AS REQUIRED.

ADD TOLERANCE EC NO: UCP2013-2933 DRAWN:WHIPPLE 2013/01/16 CHK'D:WOLFE 2013/01/16 APPR:SMILLER 2013/01/12		DESCRIPTION	QUALITY SYMBOLS ▽=0 ▽=0 ▽=0	GENERAL TOLERANCES (UNLESS SPECIFIED)		DIMENSION STYLE MM ONLY		SCALE 4:1	DESIGN UNITS METRIC	THIRD ANGLE PROJECTION				
					mm	INCH	DRAWN BY JJOONIAK	DATE 2006/01/05	TITLE VHDM/HSD LEADFREE POWER 8 ROW BACKPLANE SALES ASSEMBLY					
				4 PLACES	± ---	± ---	CHECKED BY JB INGHAM	DATE 2001/10/05						
				3 PLACES	± ---	± ---	APPROVED BY BIXLER		DATE 2001/10/05	DOCUMENT NO. SD-74029-089 SHEET NO. 1 OF 1				
				2 PLACES	± 0.25	± ---	MATERIAL NO. 74029-8999		SIZE B					
1 PLACE	± 0.38	± ---	DRAFT WHERE APPLICABLE MUST REMAIN WITHIN DIMENSIONS											